



INFRASTRUCTURE MODERNIZATION ACT OF 2018
EMERGENCY ROAD AND BRIDGE REPAIR FUND PROJECT

and

BOARD OF SUPERVISORS

JACKSON

County

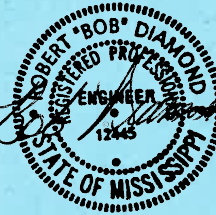

PROPOSAL AND CONTRACT DOCUMENTS

FOR THE CONSTRUCTION OF

ERBRF PROJECT NO. ERBR-30(02)

PARKERS LAKE BRIDGE

Being a Section of County Road in JACKSON

County, Mississippi

TYPE OF CONSTRUCTION Bridge Replacement with Approach Roadway

BRIDGE NUMBER(S) Bridge NO. SA30-036 Replaced With Bridge NO. SA30-A036

Net Length Miles 0.45 MI.

Gross Length Miles 0.45 MI. Contract Time 300 Working Days

By

Address

Surety

Note

Standard Specifications for State Aid Road and Bridge Construction currently approved by the Office of State Aid Road Construction and the Federal Highway Administration are made a part hereof fully and completely as if attached hereto, except where superseded by the Special Provisions, or amended by revisions.

JACKSON COUNTY BOARD OF SUPERVISORS
EMERGENCY ROAD AND BRIDGE REPAIR FUNDED PROJECT

SECTION 900

NOTICE TO CONTRACTORS:

Notice is hereby given that sealed or electronic bids will be received by the Board of Supervisors of Jackson County, Mississippi until 12:00 p.m. on the 24 day of November, **2020**, and said bids are to be opened at 1:00 p.m. after the receipt thereof and read aloud in the Board of Supervisors' Meeting Room located in the Jackson County Services Building, 2915 Canty Street, Pascagoula, MS 39567.

Envelopes containing the bid must be sealed, addressed to The Clerk of the Board of Jackson County, and designated as bids for the construction of Parkers Lake Bridge, ERBR-30 (02).

Contractors have the option of submitting their bids sealed in an envelope or electronically through www.jacksoncoplans.com. If a sealed envelope bid is submitted by mail, the post office address of the Chancery Clerk is P.O. Box 998, Pascagoula, MS 39568. Bids may be delivered to Josh Eldridge, Chancery Clerk, c/o Land Records Department, 2915 Canty Street, Suite R, Pascagoula, MS 39567.

All bid envelopes should contain the bidder's name and mailing address on the outside of the envelope and specify the name of the bid item. Proposals must be accompanied by a Proposal Guaranty consisting of a Bid Bond, Cashier's Check or Certified Check in the amount of 5% of the amount of the bid.

Bidder's certificate of responsibility number or a statement that the bid inside is less than \$50,000 shall appear on the outside or exterior of the envelope or container of such bids, failing which, said bid shall not be opened or considered.

Copies of the Contract Documents may be examined at the following locations:

- Batson & Brown, Inc; 4347 Old Spanish Trail; Gautier, MS 39553
- AGC Plan Room; 12272 Intraplex Parkway; Gulfport, MS 39503
- ABC Plan Room; 10480 Corporate Drive, Suite 2; Gulfport, MS 39503
- Or online at www.jacksoncoplans.com.

This project allows for a Contract Time of 300 Calendar Days and shall be constructed in accordance with the latest edition of the Mississippi Standard Specifications for State Aid Road and Bridge Construction.

PLANS AND PROPOSALS may be secured online from the reference website or obtained from the offices of Batson & Brown, Inc., 4347 Old Spanish Trail, Gautier, MS 39553, or either 11267 Old 63 South, Lucedale, MS, 39452, upon payment of \$250.00 (non-refundable) for each set.

For an electronic bid, documents can be downloaded from Plan House Plan Room. Electronic bids shall be submitted at www.jacksoncoplans.com. For any questions relating to the electronic bidding process, please call Plan House Plan Room at 662-407-0193.

The Board of Supervisors hereby notifies all bidders that it will affirmatively insure that in any contract entered into pursuant to this advertisement; minority business enterprise will be afforded full opportunity to submit bids in response to this invitation and will not be discriminated against on the grounds of race, color, or national origin in consideration for an award.

The County reserves the right to reject all bids, to waive any informalities and to postpone the award of the Contract for a period of time which, however, shall not extend beyond 60 days from the bid opening date.

Barry Cumbest, President
Jackson County Board of Supervisors

Publication dates:

October 25, 2020

November 1, 2020

For the construction of: BRIDGE REPLACEMENT AND APPROACH ROADWAY on 0.45 mile(s) of county road known as Wade-Vancleave Road in JACKSON County, Mississippi under JACKSON COUNTY ERBR-30(02)

I (We) agree to complete the entire project within 300 calendar days.

SPECIAL NOTICE TO BIDDERS

BIDS WILL NOT BE CONSIDERED UNLESS BOTH UNIT PRICES AND ITEM TOTALS ARE ENTERED

| Ref. No. | Pay Item No. | Work Description | Approx. Quantity | Unit | Unit Price | Item Total |
|----------------------|--------------|--|------------------|------|------------|------------|
| Roadway Items | | | | | | |
| 1 | S-200-A | MOBILIZATION | 1 | LS | | |
| 2 | S-201-A | CLEARING AND GRUBBING | 1 | LS | | |
| 3 | S-202-B | REMOVAL OF EXISTING BRIDGE (STA. 20+88.53) | 1 | UNIT | | |
| 4 | S-202-D | REMOVAL OF ASPHALT PAVING (ALL DEPTHS) | 4761 | SQ | | |
| 5 | S-203-A | UNCLASSIFIED EXCAVATION (FM) | 1238 | CY | | |
| 6 | S-203-E | BORROW EXCAVATION (CONTRACTOR FURNISHED) (LVM) (CLASS 7) | 59590 | CY | | |
| 7 | S-240-A | GEOGRID TYPE III (TRIAxIAL TYPE - TX160 OR EQUIV.) | 5858 | SQ | | |
| 8 | S-304-C | CRUSHED STONE (SIZE 610) (LVM) | 3501 | CY | | |
| 9 | S-403-A | HOT MIX ASPHALT, ST, 9.5 MM | 517 | TON | | |
| 10 | S-403-A | HOT MIX ASPHALT, ST, 12.5 MM | 1123 | TON | | |
| 11 | S-406-A | COLD MILLING OF BITUMINOUS PAVEMENT, ALL DEPTHS | 367 | SY | | |
| 12 | S-606-B | GUARDRAIL, "W" BEAM | 275 | LF | | |
| 13 | S-606-D | GUARDRAIL, BRIDGE END SECTION, TYPE "I" THRIE BEAM | 4 | EA | | |
| 14 | S-606-E | GUARDRAIL, TERMINAL END SECTION | 4 | EA | | |
| 15 | S-617-A | RIGHT-OF-WAY MARKERS (TYPE "I") | 10 | EA | | |
| 16 | S-618-A | MAINTENANCE OF TRAFFIC | 1 | LS | | |
| 17 | S-618-B | ADDITIONAL CONSTRUCTION SIGNS | 0 | SF | 10.00 | 0.00 |
| 18 | S-619-E | 4" WIDE TEMPORARY TRAFFIC STRIPE (CONTINUOUS YELLOW) | 3698 | LF | | |
| 19 | S-619-E | 4" WIDE TEMPORARY TRAFFIC STRIPE (CONTINUOUS WHITE) | 3524 | LF | | |
| 20 | S-619-E | 4" WIDE TEMPORARY TRAFFIC STRIPE (WHITE DETAIL) | 126 | LF | | |
| 21 | S-620-C | 4" WIDE COLD PLASTIC EDGE STRIPE (CONTINUOUS WHITE) | 0.21 | MI | | |
| 22 | S-620-E-1 | 4" WIDE COLD PLASTIC EDGE STRIPE (CONTINUOUS YELLOW) | 1104 | LF | | |

SECTION 902 PROPOSAL
PAGE 2

SPECIAL NOTICE TO BIDDERS

BIDS WILL NOT BE CONSIDERED UNLESS BOTH UNIT PRICES AND ITEM TOTALS ARE ENTERED

| Ref. No. | Pay Item No. | Work Description | Approx. Quantity | Unit | Unit Price | Item Total |
|---|--------------|--|------------------|------|------------|------------|
| ROADWAY ITEMS CONTINUED | | | | | | |
| 23 | S-621-C | 4" WIDE THERMOPLASTIC EDGE STRIPE (CONTINUOUS WHITE)(60 MILS) | 0.67 | MI | | |
| 24 | S-621-E-1 | 4" WIDE THERMOPLASTIC TRAFFIC STRIPE (CONTINUOUS YELLOW) (90 MILS) | 3698 | LF | | |
| 25 | S-621-H-1 | THERMOPLASTIC LEGEND (WHITE)(120 MILS) | 126 | LF | | |
| 26 | S-627-J | TWO-WAY CLEAR REFLECTIVE HIGH PERFORMANCE RAISED MARKER | 60 | EA | | |
| 27 | S-627-L | TWO-WAY YELLOW REFLECTIVE HIGH PERFORMANCE RAISED MARKER | 10 | EA | | |
| 28 | S-630-B | REFLECTORIZED TRAFFIC REGULATORY SIGN (ENCAPSULATED LENS) | 2 | EA | | |
| 29 | S-630-C | REFLECTORIZED TRAFFIC OBJECT MARKER(ENCAPSULATED LENS) TYPE 3 | 4 | EA | | |
| 30 | S-631-A | FLOWABLE FILL | 240 | CY | | |
| 31 | S-815-E | GEOTEXTILE UNDER BRIDGE END TREATMENT, TYPE V, A.C.S. 0.21 - 0.43 | 372 | SY | | |
| Subtotal Roadway Items = | | | | | | |
| EROSION CONTROL ITEMS | | | | | | |
| 32 | S-211-B | TOPSOIL FOR SLOPE TREATMENT (CONTRACT FURNISHED) (LVM) | 2652 | CY | | |
| 33 | 901-S-212-A | AGRICULTURAL LIMESTONE | 6.2 | TON | | |
| 34 | S-212-B | COMMERCIAL FERTILIZER (13-13-13) | 3.1 | TON | | |
| 35 | S-212-F | AMMONIUM NITRATE | 0.80 | TON | | |
| 36 | S-214-A | SEEDING | 3.1 | ACRE | | |
| 37 | S-215-A | VEGETATIVE MATERIALS FOR MULCH | 6.2 | TON | | |
| 38 | S-226-A | SOLID SODDING | 2500 | SY | | |
| 39 | S-227-A | EXCELSIOR BLANKET | 15910 | SY | | |
| 40 | S-233-A | TEMPORARY SILT FENCE (TYPE I)(AOS 0.15-0.84) | 2878 | LF | | |
| 41 | 907-237-A | WATTLE 20" | 740 | LF | | |
| Subtotal Erosion Control Items = | | | | | | |

SPECIAL NOTICE TO BIDDERS

BIDS WILL NOT BE CONSIDERED UNLESS BOTH UNIT PRICES AND ITEM TOTALS ARE ENTERED

| Ref. No. | Pay Item No. | Work Description BRIDGE ITEMS | Approx. Quantity | Unit | Unit Price | Item Total |
|-------------------------|--------------|--|------------------|------|------------|------------|
| 42 | 901-S-803-I | PDA TEST PILE | 4 | EA | | |
| 43 | S-803-B | CONVENTIONAL STATIC PILE LOAD TEST | 2 | EA | | |
| 44 | S-803-C | 14" PRESTRESSED CONCRETE PILING | 1275 | LF | | |
| 45 | S-803-C | 18" PRESTRESSED CONCRETE PILING | 1885 | LF | | |
| 46 | S-803-F | 18" PRE-FORMED PILE HOLE | 540 | LF | | |
| 47 | S-803-F | 24" PRE-FORMED PILE HOLE | 420 | LF | | |
| 48 | 901-S-803-J | PILE RESTRIKE | 4 | EA | | |
| 49 | S-803-K | DRILLED SHAFT, 72" DIAMETER | 816 | LF | | |
| 50 | S--803-M | TRIAL SHAFT 72" DIAMETER | 134 | EA | | |
| 51 | S-803-N | EXPLORATION | 120 | LF | | |
| 52 | S-803-O | TEMPORARY CASING, 72" DIAMETER | 450 | LF | | |
| 53 | S-804-A | BRIDGE CONCRETE, CLASS AA | 850.7 | CY | | |
| 54 | S-804-C | 110' PRESTRESSED CONCRETE BEAM, TYPE 1+2 | 3842 | LF | | |
| 55 | S-805-A | REINFORCEMENT | 150724 | LBS | | |
| 56 | S-813-A | CONCRETE RAILING | 1100.00 | LF | | |
| 57 | S-815-A | LOOSE RIPRAP, 300 LB. | 1414.0 | TON | | |
| 58 | S-815-E | GEOTEXTILE UNDER RIPRAP, TYPE V A.O.S. 0.21-0.43 | 2619 | SQ | | |
| Subtotal Bridge Items = | | | | | | |
| Total Bid = | | | | | | |

STATE OF MISSISSIPPI
JACKSON COUNTY BOARD OF SUPERVISORS
INFRASTRUCTURE MODERNIZATION ACT OF 2013
EMERGENCY ROAD AND BRIDGE REPAIR FUNDED PROJECT
PARKERS LAKE BRIDGE, WADE VANCLEAVE ROAD
ERBRF PROJECT NO. ERBR-30(02)
JACKSON COUNTY

LENGTH DATA

EXCEPTIONS

NONE

EQUATIONS

NONE

| | | |
|---------------------------|--------------|----------|
| LENGTH OF ROADWAY | 1,848.94 FT. | 0.35 MI. |
| LENGTH OF BRIDGES | 552.25 FT. | 0.10 MI. |
| LENGTH OF PROJECT (NET) | | 0 MI. |
| LENGTH OF EXCEPTIONS | | 0.45 MI. |
| LENGTH OF PROJECT (GROSS) | 2,401.19 FT. | 0.45 MI. |

PLAN 1" = 50'
PROFILE HORIZ: 1" = 50'
VERT: 1" = 5'
TITLE 1" = 2640'

BRIDGE REPLACES BRIDGE NO.
SA-30-036
WITH SA-30-A036

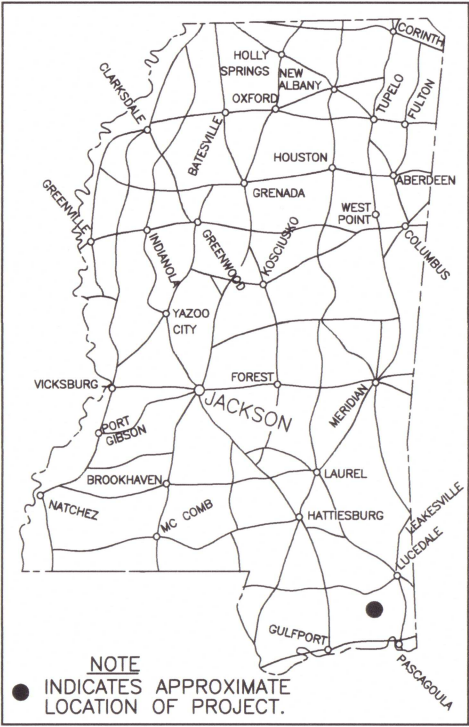
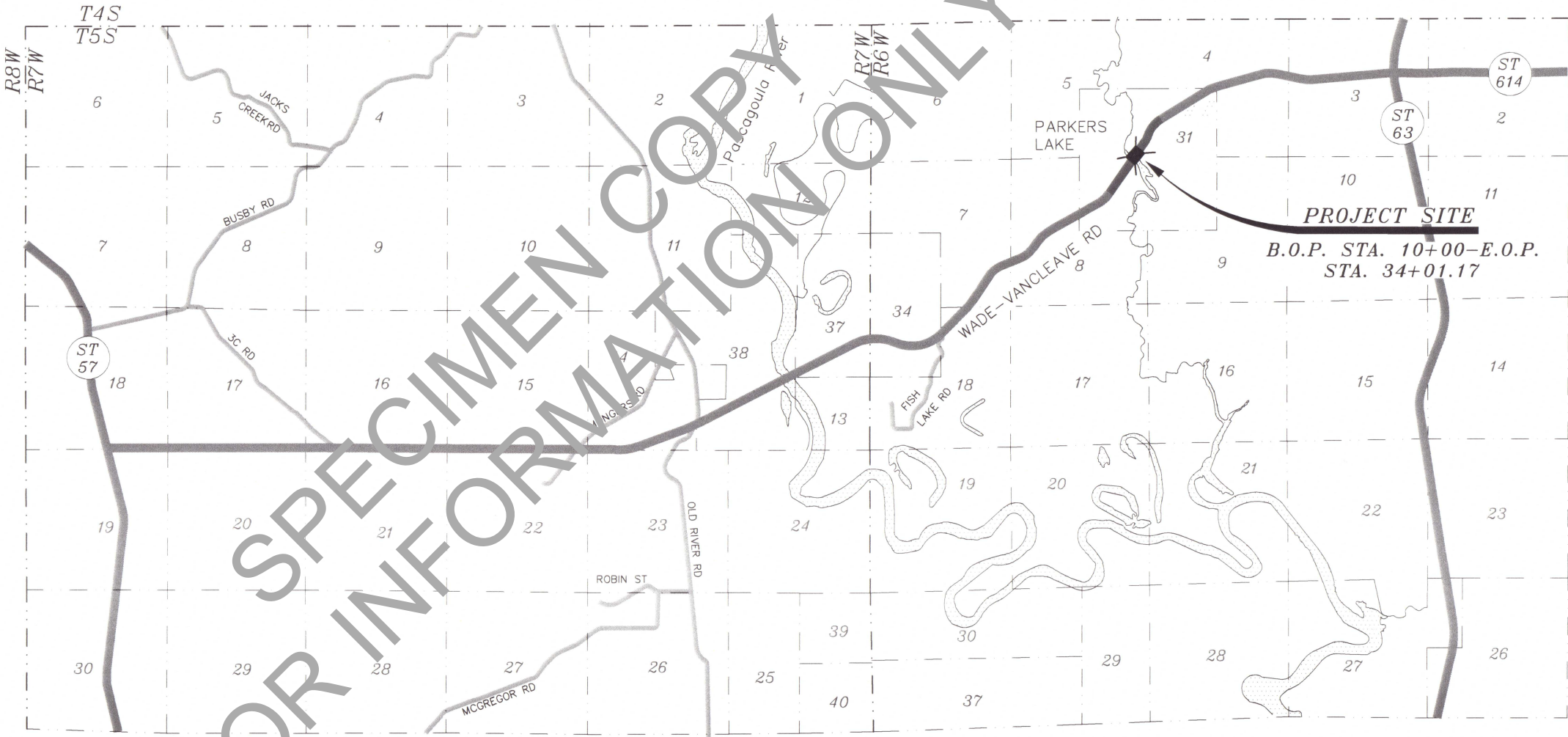

INDEX

FOR INDEX SEE SHEET NO. 2

BOARD OF SUPERVISORS

- | | |
|---------------|--------------|
| BARRY CUMBEST | - DISTRICT 1 |
| MELTON HARRIS | - DISTRICT 2 |
| KEN TAYLOR | - DISTRICT 3 |
| TROY ROSS | - DISTRICT 4 |
| RANDY BOSARGE | - DISTRICT 5 |

COUNTY ROAD MANAGER

- | | |
|-----------------|-------------------|
| JOE O'NEAL | - ROAD MANAGER |
| WENDY BROUSSARD | - COUNTY ENGINEER |



PLANS DESIGNED BY:

Batson and Brown
Engineers and Surveyors

NEEL-SCHAFER
Solutions you can build upon

PREPARED BY

Bob Diamond

PROJECT ENGINEER

10/26/2020

DATE

STANDARD SPECIFICATIONS FOR STATE AID ROAD AND BRIDGE CONSTRUCTION CURRENTLY APPROVED BY THE OFFICE OF STATE AID ROAD CONSTRUCTION OF THE MISSISSIPPI DEPARTMENT OF TRANSPORTATION AND THE FEDERAL HIGHWAY ADMINISTRATION ARE MADE A PART HEREOF FULLY AND COMPLETELY AS IF ATTACHED HERETO, EXCEPT WHERE SUPERSEDED BY THE SPECIAL PROVISIONS, OR AMENDED BY REVISIONS.

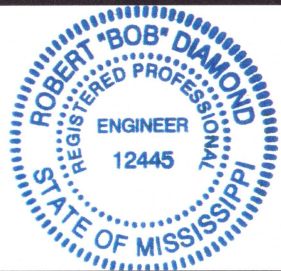

PREPARED BY
Bob Diamond
PROJECT ENGINEER
10/26/2020
DATE

SUMMARY OF QUANTITIES

| SUMMARY OF QUANTITIES | | | | |
|-----------------------|--|----------|-------|----------|
| PAY ITEM NO. | PAY ITEM | QUANTITY | | UNITS |
| | | PLAN | FINAL | |
| ROADWAY ITEMS | | | | |
| S-200-A | MOBILIZATION | LUMP SUM | | LUMP SUM |
| S-201-A | CLEARING AND GRUBBING | LUMP SUM | | LUMP SUM |
| S-202-A | REMOVAL OF BRIDGE | 1 | | UNIT |
| S-202-D | REMOVAL OF ASPHALT PAVING (ALL DEPTHS) | 4761 | | SQ. YD. |
| S-203-A | UNCLASSIFIED (FM) | 1238 | | CU. YD. |
| S-203-E | BORROW EXCAVATION (CONTRACTOR FURNISHED LVM, CLASS 7) | 59590 | | CU. YD. |
| S-240-A | GEOGRID, TYPE III | 5858 | | SQ. YD. |
| S-304-C | CRUSHED STONE (LVM)(SIZE 610) | 3501 | | CU. YD. |
| S-403-A | HOT MIX ASPHALT, (ST)(9.5mm) | 517 | | TON |
| S-403-A | HOT MIX ASPHALT, (ST)(12.5mm) | 1123 | | TON |
| S-406-A | COLD MILLING OF BITUMINOUS PAVEMENT, ALL DEPTHS | 367 | | SQ. YD. |
| S-606-B | GUARDRAIL "W" BEAM | 275 | | L.F. |
| S-606-D | GUARDRAIL, BRIDGE END SECTION, TYPE "I" THRIE BEAM | 4 | | EACH |
| S-606-E | GUARDRAIL, TERMINAL END SECTION | 4 | | EACH |
| S-617-A | RIGHT-OF-WAY MARKERS (TYPE I) | 10 | | EACH |
| S-618-A | MAINTENANCE OF TRAFFIC | LUMP SUM | | LUMP SUM |
| S-618-B | ADDITIONAL CONSTRUCTION SIGNS | 0.0 | | SQ. FT. |
| S-619-E | 4" WIDE TEMPORARY TRAFFIC STRIPE (CONTINUOUS YELLOW) | 3698 | | L.F. |
| S-619-E | 4" WIDE TEMPORARY TRAFFIC STRIPE (CONTINUOUS WHITE) | 3524 | | L.F. |
| S-619-E | 4" WIDE TEMPORARY TRAFFIC STRIPE (WHITE DETAIL) | 126 | | L.F. |
| S-620-C | 4" WIDE COLD PLASTIC EDGE STRIPE (CONTINUOUS WHITE) | 0.21 | | MI. |
| S-620-E-1 | 4" WIDE COLD PLASTIC EDGE STRIPE (CONTINUOUS YELLOW) | 1104 | | L.F. |
| S-621-C | 4" WIDE THERMOPLASTIC EDGE STRIPE (CONTINUOUS WHITE)(60 MILS) | 0.67 | | MI. |
| S-621-E-1 | 4" WIDE THERMOPLASTIC TRAFFIC STRIPE (CONTINUOUS YELLOW)(90 MILS) | 3698 | | L.F. |
| S-621-H-1 | THERMOPLASTIC LEGEND (WHITE)(120 MILS) | 126 | | L.F. |
| S-627-J | TWO-WAY CLEAR REFLECTIVE HIGH PERFORMANCE RAISED MARKERS | 60 | | EACH |
| S-627-L | TWO-WAY YELLOW REFLECTIVE HIGH PERFORMANCE RAISED MARKERS | 10 | | EACH |
| S-630-B | REFLECTORIZED TRAFFIC REGULATORY SIGN (ENCAPSULATED LENS) | 2 | | EACH |
| S-630-C | REFLECTORIZED TRAFFIC OBJECT MARKER SIGN (ENCAPSULATED LENS)(TYPE 3) | 4 | | EACH |
| S-631-A | FLOWABLE FILL | 240 | | CU. YD. |
| S-815-E | GEOTEXTILE UNDER BRIDGE END TREATMENT, TYPE V, A.O.S. 0.21-0.43 | 372 | | SQ. YD. |
| EROSION CONTROL ITEMS | | | | |
| S-211-B | TOPSOIL FOR SLOPE TREATMENT (CONTR FURNISHED)(LVM) | 2652 | | CU. YD. |
| 901-S-212-A | AGRICULTURAL LIMESTONE | 6.2 | | TON |
| S-212-B | COMMERCIAL FERTILIZER (13-13-13) | 1 | | TON |
| S-212-F | AMMONIUM NITRATE | 0.8 | | TON |
| S-214-A | SEEDING | 3.1 | | ACRE |
| S-215-A | VEGETATIVE MATERIALS FOR MULCH | 6.2 | | TON |
| S-226-A | SOLID SODDING | 250 | | SQ. YD. |
| S-227-A | EXCELSIOR BLANKET | 1910 | | SQ. YD. |
| S-233-A | TEMPORARY SILT FENCE (TYPICAL)(AOS 0.15-0.84) | 28.3 | | L.F. |
| 237-A | WATTLES, 20" | 740 | | L.F. |

SUMMARY OF QUANTITIES (CONT.)

| PAY ITEM NO. | PAY ITEM | QUANTITY | | UNITS |
|--------------|---|----------|-------|---------|
| | | PLAN | FINAL | |
| BRIDGE ITEMS | | | | |
| 901-S-803-I | PDA TEST PILE | 4 | | EACH |
| S-803-B | CONVENTIONAL STATIC PILE LOAD TEST | 2 | | EACH |
| S-803-C | 14" PRESTRESSED CONCRETE PILING | 1275 | | L.F. |
| S-803-C | 18" PRESTRESSED CONCRETE PILING | 1885 | | L.F. |
| S-803-F | 18" PRE-FORMED PILE HOLE | 540 | | L.F. |
| S-803-F | 24" PRE-FORMED PILE HOLE | 420 | | L.F. |
| 901-S-803-J | PILE RESTRIKE | 4 | | EACH |
| S-803-K | DRILLED SHAFT, 72" DIAMETER | 816 | | L.F. |
| S-803-M | TRIAL SHAFT, 72" DIAMETER | 134 | | L.F. |
| S-803-N | EXPLORATION | 120 | | L.F. |
| S-803-O | TEMPORARY CASING, 72" DIAMETER | 450 | | L.F. |
| S-804-A | BRIDGE CONCRETE, CLASS AA | 850.7 | | CU. YD. |
| S-804-C | 110' PRESTRESSED CONCRETE BEAM, TYPE 1+2 | 3842 | | L.F. |
| S-805-A | REINFORCEMENT | 150724 | | LBS |
| S-813-A | CONCRETE RAILING | 1100 | | L.F. |
| S-815-A | LOOSE RIPRAP, 300 LB | 1414 | | TON |
| S-815-E | GEOTEXTILE UNDER RIPRAP, TYPE V, A.O.S. 0.21-0.43 | 2619 | | SQ. YD. |
| | | | | |

- ① 1,000 SQ. YD'S. GEOGRID TO BE USED AS DIRECTED BY THE ENGINEER.
- ② QUANTITIES BASED ON 6" THICKNESS. THICKNESS APPLIED TO ROADWAY SHALL BE DETERMINED BY THE ENGINEER BEFORE PLACEMENT. (INCLUDES 165 CU. YD. TO BE USED AS DIRECTED BY ENGINEER.)
- ③ VANDAL RESISTANT HARDWARE REQUIRED.
- ④ TO BE USED UNDER BRIDGE ABUTMENTS.
- ⑤ 500 SQ. YD'S. SOLID SOD TO BE USED AS DIRECTED BY THE ENGINEER.
- ⑥ PER MISSISSIPPI STANDARD SPECIFICATIONS FOR ROAD AND BRIDGE CONSTRUCTION, MDOT, 2017 EDITION.
- ⚡ CEMENTITIOUS EXPOSURE TO SULFATES IS NEGLIGIBLE.

NOTE:
INCIDENTAL WORK FOR WHICH NO PAY ITEM IS PROVIDED IN THE PROPOSAL SHALL BE CONSIDERED INCLUDED IN THE PRICES AND PAYMENT FOR BID ITEMS.

| | | | |
|-----------------------|-------------------|--|--|
| REVISED 10/21/2020 | DATE: 02/19/19 | QUANTITY SHEET | |
| COMPLETED | DR. BY MASON | | |
| | CHECKED BOB | | |
| | SCALE N.T.S. | | |
| | | BATSON AND BROWN, INC. GAUTIER □ LUCEDALE □ PASCAGOULA, MISSISSIPPI | |
| | | CONSULTING ENGINEERS | |

TOTAL LENGTH OF BRIDGE = 552.25'
40'-0" CLEAR ROADWAY
5 @ 110' PRESTRESSED CONCRETE BEAM SPAN

