

STATE OF MISSISSIPPI
 OFFICE OF STATE AID ROAD CONSTRUCTION
 PLAN AND PROFILE OF PROPOSED
 COUNTY HIGHWAY
 STATE AID PROJECT NO. SAP-84(1)S

LENGTH DATA

EXCEPTIONS

See Sheet No. 1-A

EQUATIONS

See Sheet No. 1-A

LENGTH OF ROADWAY	23.012 MI
LENGTH OF BRIDGES	0.000 MI
LENGTH OF PROJECT (NET)	23.012 MI
LENGTH OF EXCEPTIONS	0.092 MI
LENGTH OF PROJECT (GROSS)	23.104 MI

ROADS "A" - "H"
 MISSISSIPPI COUNTY

SCALE

LAYOUT 1 IN. = 12,000 FT.

INDEX
 FOR INDEX SEE SHEET NO. 2

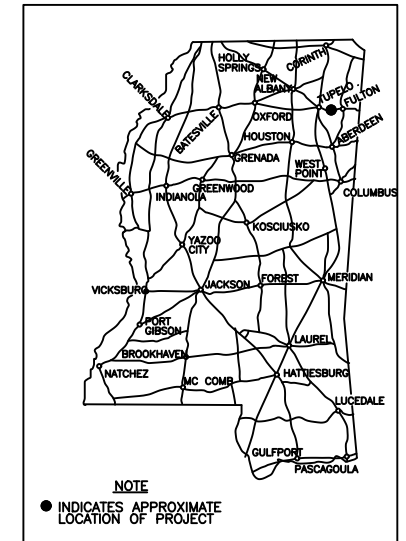

NOTE
 ● INDICATES APPROXIMATE LOCATION OF PROJECT

NOTE TO DESIGNER:

SAMPLE PLAN DATA
 Type of Project: RESEAL
 MARCH 2022

Notes To Designer are in italics throughout these sample plans and should not be included in project plans.

MISSISSIPPI STANDARD SPECIFICATIONS FOR STATE AID ROAD AND BRIDGE CONSTRUCTION CURRENTLY APPROVED BY THE OFFICE OF STATE AID ROAD CONSTRUCTION ARE MADE A PART HEREOF FULLY AND COMPLETELY AS IF ATTACHED HERETO, EXCEPT WHERE SUPERSEDED BY THE SPECIAL PROVISIONS, OR AMENDED BY REVISIONS.

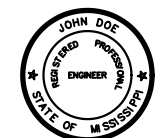
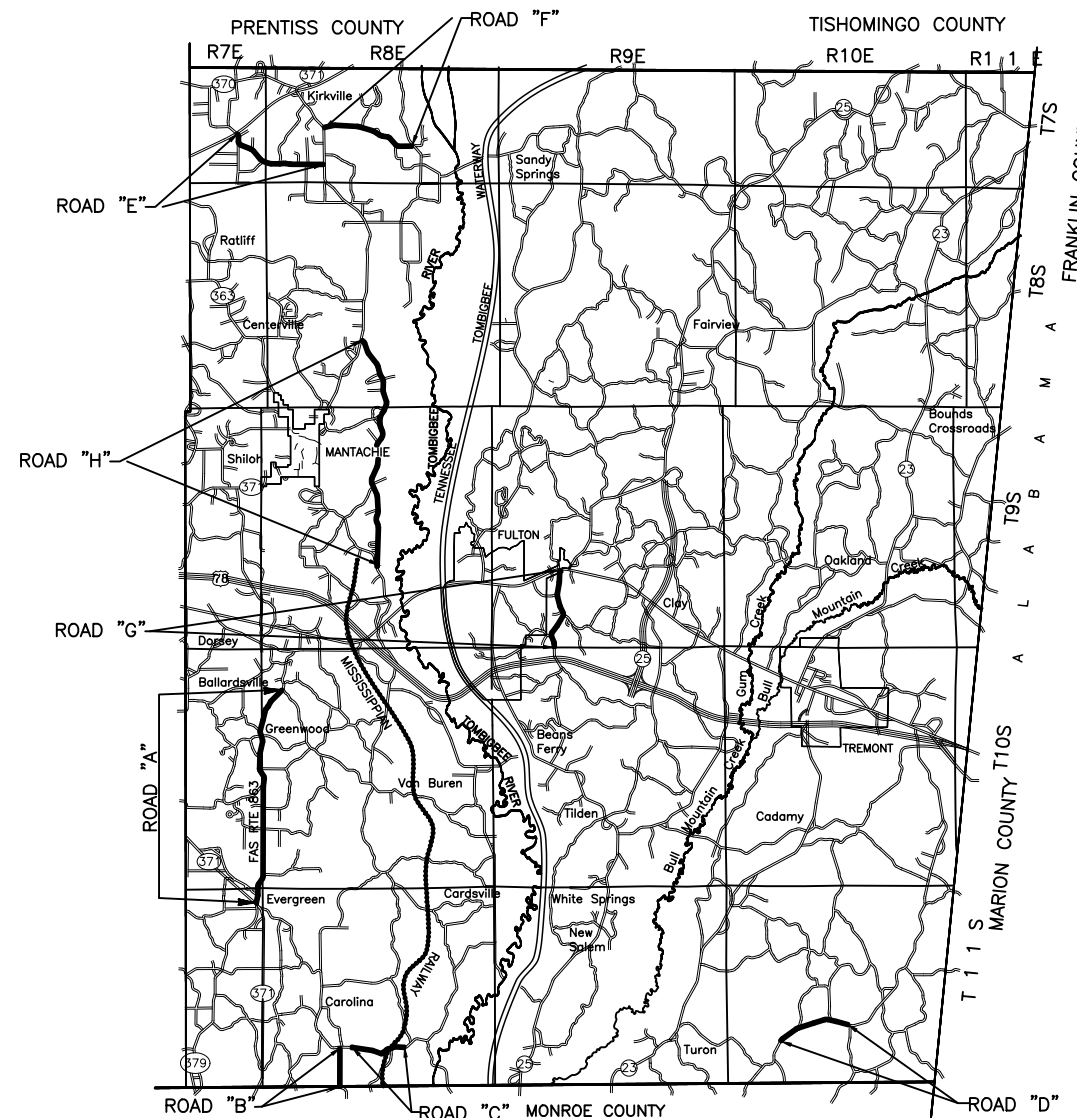

PREPARED BY _____ DATE _____
 COUNTY ENGINEER

OFFICE OF STATE AID ROAD CONSTRUCTION
 STATE AID ENGINEER _____ DATE _____

LENGTH DATA

EXCEPTIONS

ROADS "A" & "B" : NONE
 ROAD "C" : Sta. 48+20 To Sta. 49+60 = 140.0'
 Sta. 63+95 To Sta. 64+05 = 10.0'
 ROAD "D" : Sta. 347+58 To Sta. 348+18 = 60.0'
 ROAD "E" : Sta. 145+51 To Sta. 146+09.5 = 58.50'
 Sta. 211+34 To Sta. 211+54.5 = 20.50'
 ROAD "F" : Sta. 38+05 To Sta. 38+62 = 57.0'
 Sta. 44+11 To Sta. 45+65 = 154.0'
 ROAD "G" : NONE
 ROAD "H" : NONE

EQUATIONS

ROAD "A" - "F" : NONE
 ROAD "G" : Sta. 214+53.31 (BK) = Sta. 214+10.45 (AH) = +42.86'
 ROAD "H" : NONE

ROAD " A "

LENGTH OF ROADWAY 27,400.00 FT 5.189 MI
 LENGTH OF BRIDGES 0.00 FT 0.000 MI
 LENGTH OF PROJECT (NET) 5.189 MI
 LENGTH OF EXCEPTIONS 0.00 FT 0.000 MI
 LENGTH OF PROJECT (GROSS) 5.189 MI

ROAD " B "

LENGTH OF ROADWAY 5455.00 FT 1.033 MI
 LENGTH OF BRIDGES 0.00 FT 0.000 MI
 LENGTH OF PROJECT (NET) 1.033 MI
 LENGTH OF EXCEPTIONS 0.00 FT 0.000 MI
 LENGTH OF PROJECT (GROSS) 1.033 MI

ROAD " C "

LENGTH OF ROADWAY 6792.00 FT 1.286 MI
 LENGTH OF BRIDGES 0.00 FT 0.000 MI
 LENGTH OF PROJECT (NET) 1.286 MI
 LENGTH OF EXCEPTIONS 150.00 FT 0.028 MI
 LENGTH OF PROJECT (GROSS) 1.314 MI

ROAD " D "

LENGTH OF ROADWAY 11,540.00 FT 2.185 MI
 LENGTH OF BRIDGES 0.00 FT 0.000 MI
 LENGTH OF PROJECT (NET) 2.185 MI
 LENGTH OF EXCEPTIONS 60.00 FT 0.011 MI
 LENGTH OF PROJECT (GROSS) 2.196 MI

ROAD " E "

LENGTH OF ROADWAY 12,955.00 FT 2.453 MI
 LENGTH OF BRIDGES 0.00 FT 0.000 MI
 LENGTH OF PROJECT (NET) 2.453 MI
 LENGTH OF EXCEPTIONS 79.00 FT 0.014 MI
 LENGTH OF PROJECT (GROSS) 2.467 MI

ROAD " F "

LENGTH OF ROADWAY 13,579.00 FT 2.571 MI
 LENGTH OF BRIDGES 0.00 FT 0.000 MI
 LENGTH OF PROJECT (NET) 2.571 MI
 LENGTH OF EXCEPTIONS 211.00 FT 0.039 MI
 LENGTH OF PROJECT (GROSS) 2.610 MI

ROAD " G " PART "A"

LENGTH OF ROADWAY 5,900.00 FT 1.117 MI
 LENGTH OF BRIDGES 0.00 FT 0.000 MI
 LENGTH OF PROJECT (NET) 1.117 MI
 LENGTH OF EXCEPTIONS 0.00 FT 0.000 MI
 LENGTH OF PROJECT (GROSS) 1.117 MI

ROAD " G " PART "B"

LENGTH OF ROADWAY 5,846.86 FT 1.107 MI
 LENGTH OF BRIDGES 0.00 FT 0.000 MI
 LENGTH OF PROJECT (NET) 1.107 MI
 LENGTH OF EXCEPTIONS 0.00 FT 0.000 MI
 LENGTH OF PROJECT (GROSS) 1.107 MI

ROAD " H "

LENGTH OF ROADWAY 32,056.00 FT 6.071 MI
 LENGTH OF BRIDGES 0.00 FT 0.000 MI
 LENGTH OF PROJECT (NET) 6.071 MI
 LENGTH OF EXCEPTIONS 0.00 FT 0.000 MI
 LENGTH OF PROJECT (GROSS) 6.071 MI

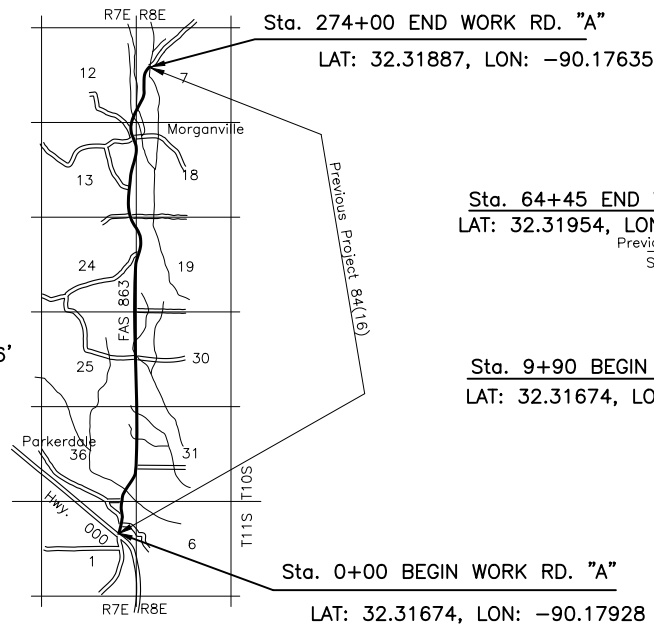

ROAD " A "
 NAME OF ROAD (Current Local Name)
 Scale: 1" = 5280'

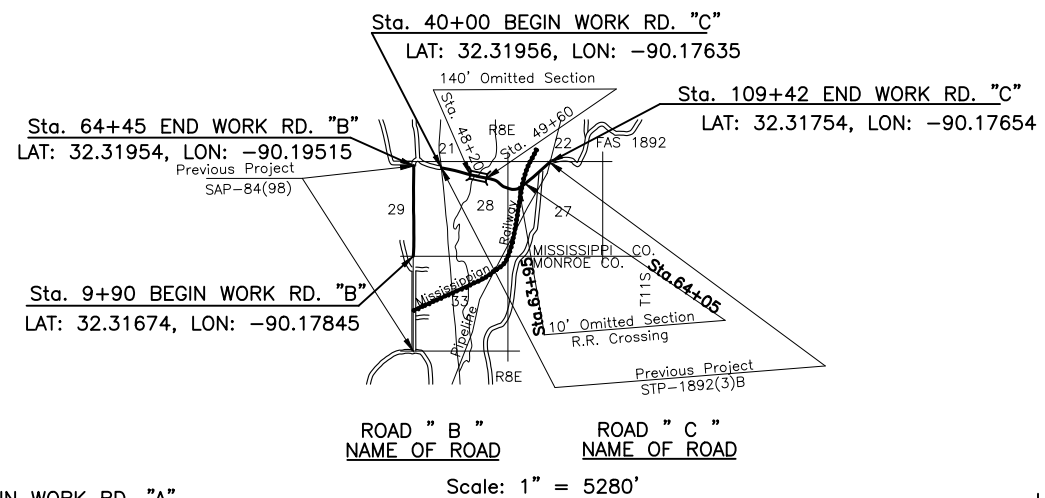

ROAD " B " ROAD " C "
 NAME OF ROAD NAME OF ROAD
 Scale: 1" = 5280'

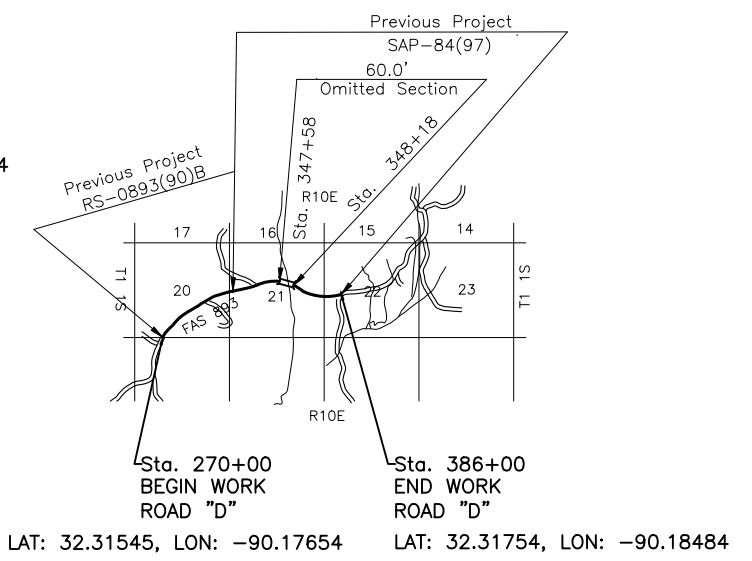

ROAD " D "
 NAME OF ROAD
 Scale: 1" = 5280'

Note: GPS shall be a decimal expressed to a minimum of 5 decimal places. The GPS data may be located in a table format indicating the location and also located on other approved sheets.

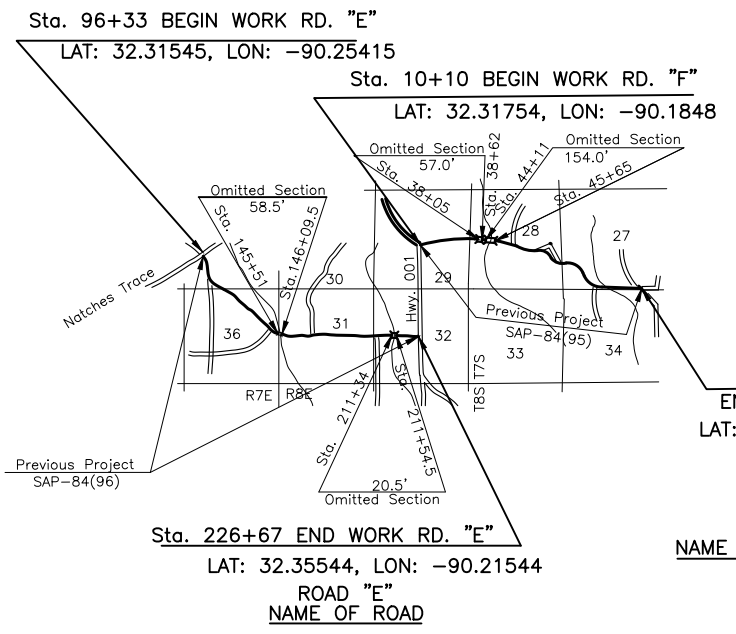

ROAD " F "
 NAME OF ROAD (Current Local Name)
 Scale: 1" = 5280'

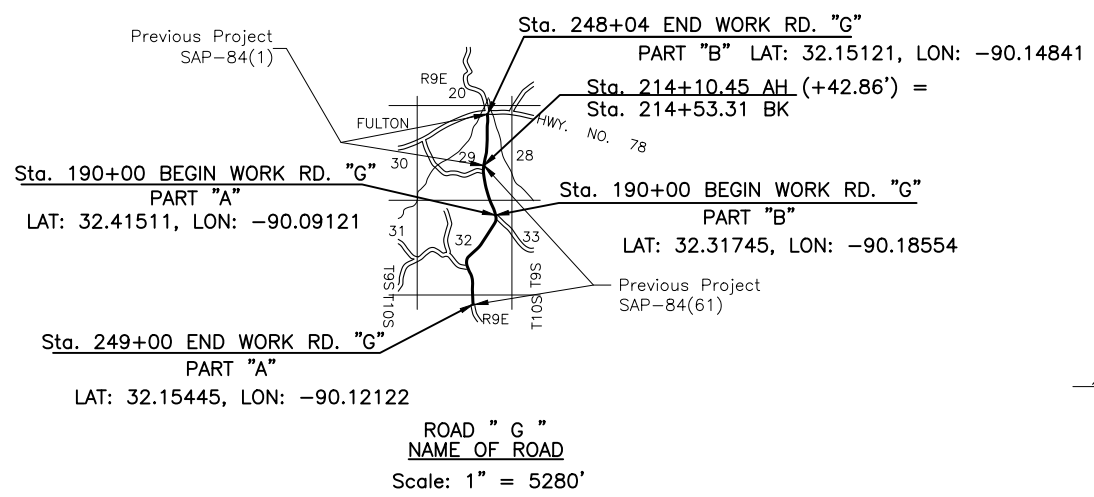

ROAD " G "
 NAME OF ROAD
 Scale: 1" = 5280'

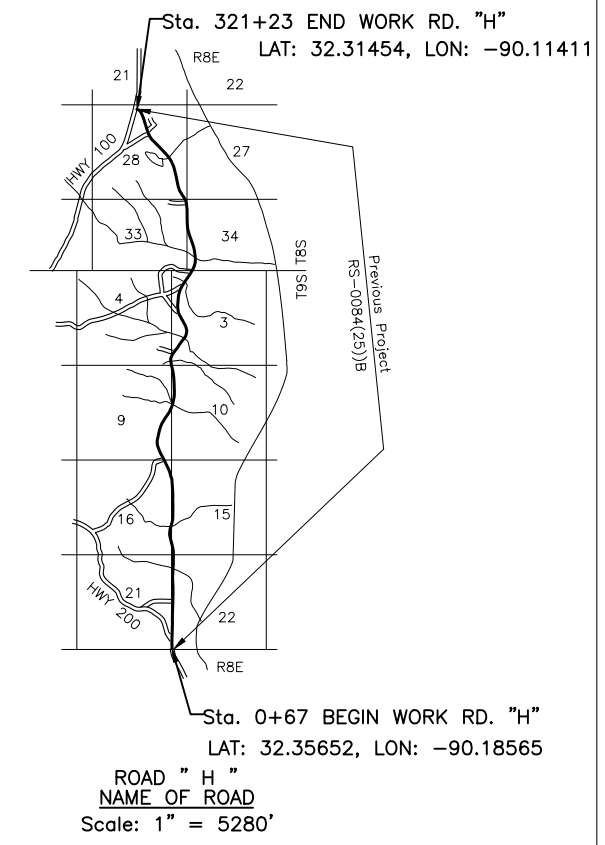

ROAD " H "
 NAME OF ROAD
 Scale: 1" = 5280'

SUMMARY OF QUANTITIES

PAY ITEM NO.	PAY ITEM ROADWAY ITEMS	TOTAL QUANTITY		UNIT
		PLAN	FINAL	
S-200-A	Mobilization	Lump Sum		Lump Sum
① S-203-A	Unclassified Excavation (F.M.)	137.0		Cu. Yd.
S-403-A	Hot Mix Asphalt, ST, 19 mm (Base Repair)	272.0		Ton
S-403-A	Hot Mix Asphalt, ST, 12.5 mm (Edge Repair)	115.0		Ton
S-403-B	Hot Mix Asphalt, ST, 12.5 mm, Leveling	328.0		Ton
S-410-C	Emulsified Asphalt, Grade CRS-2 (or CRS-2P)	129,014.0		Gal.
S-410-E	Seal Aggregate Cover Material, Size 7, Type Crushed Stone (or Size 89)	3,026.0		Cu. Yd.
S-410-F	Blotter Material	432.0		Cu. Yd.
S-618-A	Maintenance Of Traffic	Lump Sum		Lump Sum
S-618-B	Additional Construction Signs	0.0		Sq. Ft.
S-621-C	4" Wide Thermoplastic Edge Stripe (Continuous White) (90 mil)	45.856		Mile
S-621-D	4" Wide Thermoplastic Traffic Stripe (Skip Yellow) (120 mil)	12.620		Mile
S-621-E-1	4" Wide Thermoplastic Traffic Stripe (Continuous Yellow) (120 mil)	156,210		Lin. Ft.
* S-621-H-1	Thermoplastic Legend (White) (120 mil)	3,267		Lin. Ft.
S-621-H-2	Thermoplastic Legend (White) (120 mil)	126		Sq. Ft.
S-627-L	Two-Way Yellow Reflective High Performance Raised Markers	258		Each
② * S-630-A	Reflectorized Traffic Warning Sign (Encapsulated Lens)	115		Each
② S-630-B	Reflectorized Traffic Regulatory Sign (Encapsulated Lens)	36		Each
② S-630-C	Reflectorized Traffic Object Marker (Encapsulated Lens) (Type 3)	36		Each
② S-630-G	Reflectorized Traffic Warning Sign With Supp. Plate (Encapsulated Lens)	24		Each

* See Sign Detail Sheet No. 2-B for new traffic sign requirements

- ① Required For Base Repair Excavation.
- ② Vandal Resistant Hardware Required.

Note: 40 Mil Hot Spray Paint may be used on DBST or Chip Seal Surface if ADT < 800.

Base and Edge Repair quantities may be combined.

Note: No Mobilization on Striping and Signing Projects.

INDEX

SHEET NO.	TITLE
1	Title Sheet
1-A	Layout Sheet
2	Quantity & Index Sheet
2-A	Typical Section Sheet
2-B	Detail Sheet
2-C	Estimated Quantity Sheet
2-D	Base Repair Schedule Sheet
2-E	Leveling And Overlay Schedule Sheet
2-F to 2-J	Pavement Marking Details and Traffic Sign Schedule Sheet
2-K	Traffic Control Plan
SA-PSM-1	Pavement Striping & Marking Details
SA-TSP-1	Traffic Sign Placement
6057	Typical Placement of Warning Signs and Pavement Markings at R.R. - Highway Grade Crossings
6358	Highway Sign And Barricade Details For Construction Projects

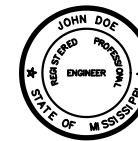

PREPARED BY _____ COUNTY ENGINEER _____ DATE _____

RATES OF APPLICATION USED FOR ESTIMATING QUANTITIES

ITEM	RATE
Hot Mix Asphalt	110 LB./SQ. YD./IN.
Emulsified Asphalt, Grade CRS-2	0.39 to 0.48 GAL./SQ. YD.
Seal Aggregate	0.28 CU. FT./SQ. YD.
Hot Mix Asphalt for Edge Repairs	5 TONS/MILE
Blotter Material	0.04 CU. FT./SQ. YD.

Rate of liquid asphalt application should be based on surface condition and type of existing surface. The rates of application should be varied by road based on the condition of each road. If application rates shown exceed those in the Specifications, Table 410-A, they should be approved by the Design Location Committee (County and District Engineer) at the PS&E plan review stage and evaluated prior to application of liquid asphalt per SOP SA II-1-91.

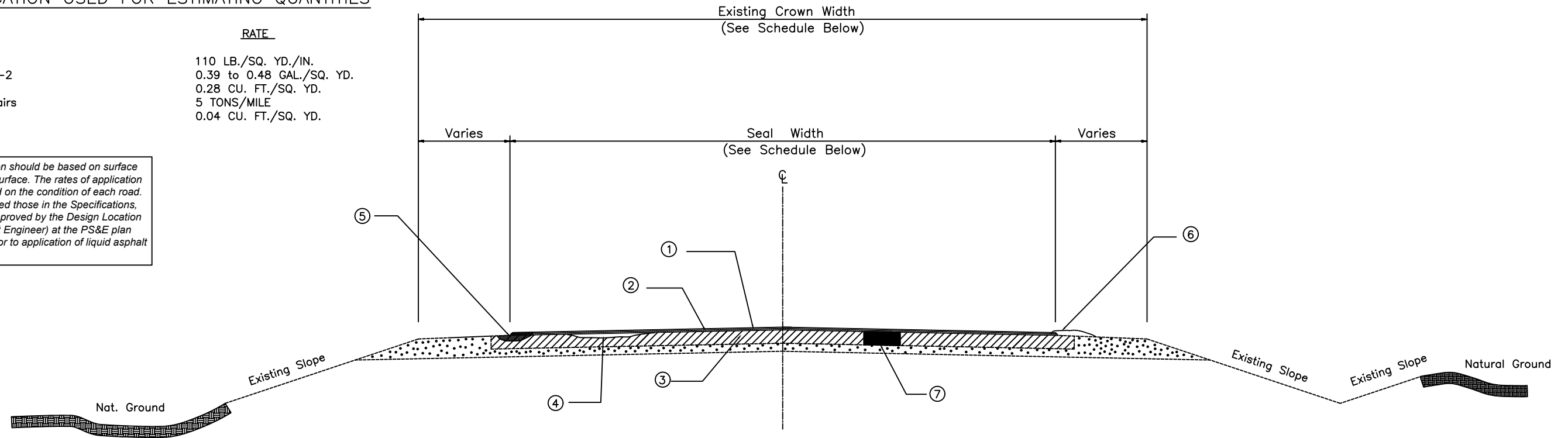

TYPICAL BASE REPAIR, LEVELING & RESEAL SECTION

GENERAL NOTES:

1. Excavated material from failed areas to be disposed outside the project limits or as directed by the engineer. Cost for excavation and disposal to be paid for as Unclassified Excavation (F.M.), Pay Item No. S-203-A.
2. Tack Coat is required before placing Hot Mix Asphalt on Edge Repairs, Base Failures or Leveling. Cost to be included in other bid items, not a separate pay item.
3. The Engineer and Contractor should evaluate each surface prior to application of liquid asphalt to determine if rates of application shown on the plans will be adequate (See SOP SA II-1-91).
4. Double seal base repairs and leveled areas as directed by the engineer.
5. Speed of striping vehicle SHALL NOT EXCEED 10 MPH during striping operations unless approved by the engineer.

ROAD	CROWN WIDTH	SEAL WIDTH	CURRENT ADT(2007)
A	28' - 30'	20'	260
B	28'	18'	610
C	34'	22'	**610
D	26' - 28'	20'	1500
E	28'	20'	**1030
F	30'	20'	1020
G	28'	22'	1190
H	28' - 32'	20'	670

** Estimated ADT

- ① Seal Coat With Liquid Asphalt and Seal Aggregate Required.
- ② Existing Pavement.
- ③ Existing Base Course.
- ④ Level Depressed Areas With Hot Mix Asphalt (ST, 9.5 mm, Leveling) Prior To Resealing (See Leveling Schedule).
- ⑤ Small Edge Failures To Be Cleaned And Patched With Hot Mix Asphalt ST, 12.5 MM. Finish Flush With The Surrounding Surface.
- ⑥ Grade Excess Shoulder Material From 1' Outside Of Edge Of Pavement Surface Before Placement Of Seal Coat.
- ⑦ Excavate Designated Failed Areas To A 6" Minimum Depth And Repair With Hot Mix Asphalt (ST, 19 mm). Finish Flush With The Surrounding Surface. See Base Repair Schedule Sheet For Locations.

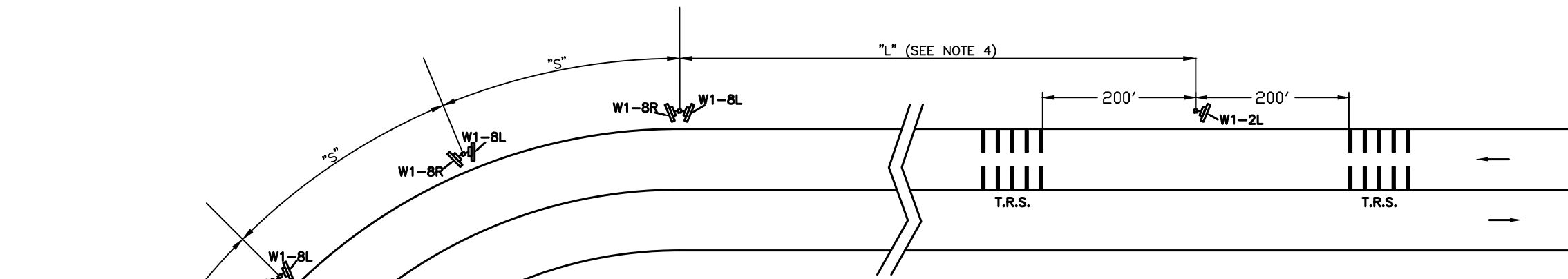

TYPICAL SPACING "S" OF CHEVRON ALIGNMENT SIGNS		
Advisory Speed	Curve Radius	Sign Spacing*
15 mph or less	Less than 200 ft.	40 ft.
20 to 30 mph	200 to 400 ft.	80 ft.
35 to 45 mph	401 to 700 ft.	120 ft.
50 to 60 mph	701 to 1,250 ft.	160 ft.
More than 60 mph	More than 1,250 ft.	200 ft.

*Approximate spacing coincides with raised pavement marker/skip strips.

Note: Last chevron facing outside lane may be single sign.

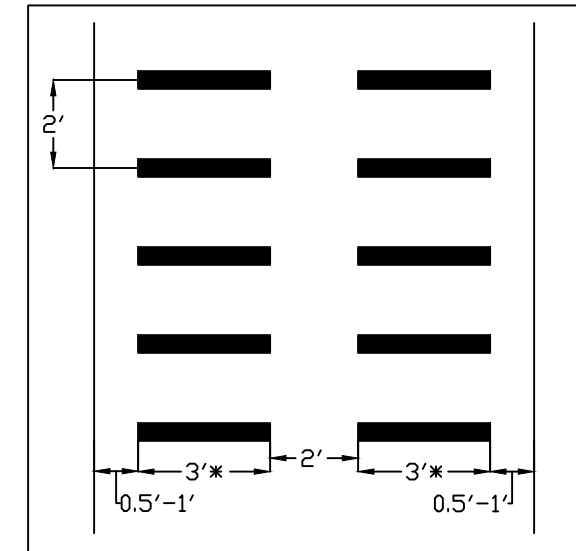

*Use 4 FT stripe for 12' lane width.

STANDARD SPACING TRANSVERSE RUMBLE STRIP (T.R.S.) DETAIL

CHEVRON ALIGNMENT SIGNS SPACING DETAIL (N.T.S.)

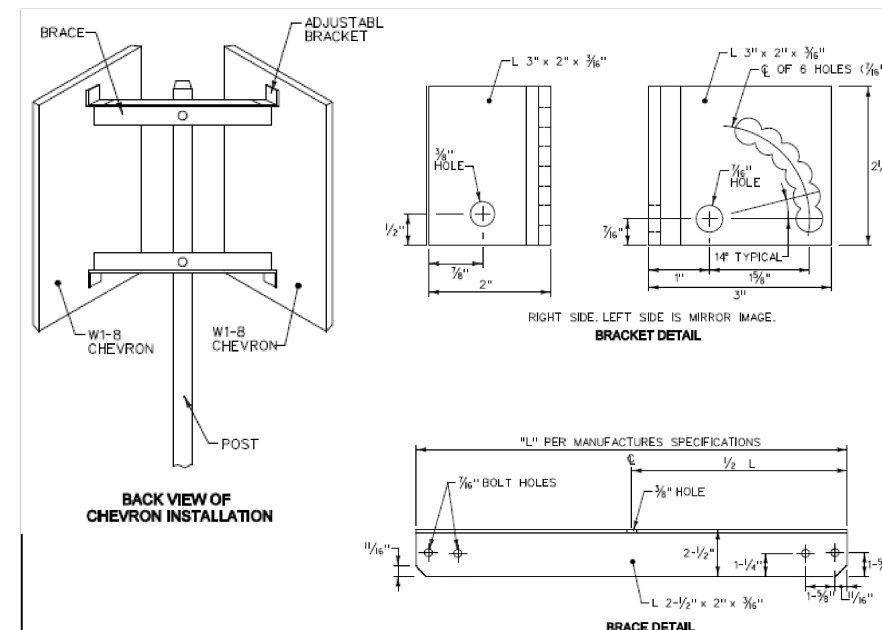

CHEVRON MOUNTING DETAIL

GENERAL NOTES:

1. Chevron Adjustable Brackets will be required for installation of two chevrons on a single post. The post, two chevron signs and bracket will be considered as a single warning sign for payment. Bracket will be required to maintain proper alignment under all weather conditions. The Adjustable Bracket shall be furnished in all aluminum or all galvanized steel products. Adjustable Bracket modifications must be approved by county engineer.
2. Transverse Rumble Strips (T.R.S.) to be normal stripe width thermoplastic legend 360 mils thickness (3-ply 120 mils) 180 LF thermoplastic legend.
3. Locate T.R.S. 200 FT before and after advance warning sign as indicated on striping sheets.
4. Spacing length "L" per the MUTCD spacing requirements.
5. A strip of retroreflective material (2-inch minimum width) shall be attached to all regulatory and warning sign posts per the MUTCD using a commercially available manufactured product subject to County Engineer approval. Cost to be included with the sign.

ESTIMATED QUANTITIES FOR RESEAL AND PAVEMENT IMPROVEMENTS													
ROAD	SEAL WIDTH	ROADWAY LENGTH	ROADWAY SEAL AREA	EXTRA AREA*	TOTAL SEAL AREA	ESTIMATED LIQUID ASPHALT RATE	EMULSIFIED ASPHALT CRS-2	SEAL AGG. COVER MATERIAL (SIZE 7)	BLOTTER MATERIAL (LVM)	UNCL. EXCAV. (FM)	BASE REPAIR (HMA ST 12.5mm)	EDGE REPAIR (HMA ST 12.5mm)	LEVELING (HMA ST 9.5mm)
	FT.	FT.	SQ. YD.	SQ. YD.	SQ. YD.	GAL/SY	GAL.	CU. YD.	CU. YD.	CU. YD.	TON	TON	TON
A	20	27,400.00	60,888.89	3,219.10	64,107.99	0.48	30,771.8	664.8	95.0	0.0	0.0	25.9	0.0
B	18	5,455.00	10,910.00	1,525.01	12,435.01	0.42	5,222.7	129.0	18.4	18.3	36.4	5.2	65.4
C	22	6,792.00	16,602.67	1,201.56	17,804.23	0.46	8,189.9	184.6	26.4	14.7	29.4	6.4	53.8
D	20	11,540.00	25,644.44	3,383.21	29,027.65	0.48	13,933.3	301.0	43.0	13.8	27.3	10.9	53.0
E	20	12,955.00	28,788.89	1,314.46	30,103.35	0.40	12,041.3	312.2	44.6	19.8	39.3	12.3	27.8
F	20	13,579.00	30,175.56	3,312.99	33,488.54	0.40	13,395.4	347.3	49.6	25.4	50.5	12.9	30.3
G PART "A"	22	5,900.00	14,422.22	1,737.30	16,159.52	0.42	6,787.0	167.6	23.9	14.4	28.7	5.6	20.4
G PART "B"	22	5,846.86	14,292.32	1,624.12	15,916.44	0.42	6,684.9	165.1	23.6	11.4	22.7	5.5	19.6
H	20	32,056.00	71,235.56	1,462.91	72,698.47	0.44	31,987.3	753.9	107.7	18.8	37.5	30.4	57.4
TOTAL PROJECT		121,523.86					129,013.7	3025.5	432.2	136.6	271.8	115.1	327.7

* Extra Areas Include Extra Width In Curves, Paved Aprons, Bridge Ends, Intersections, Turnouts And Double Seal of Hot Mix Patches and Leveling.

ESTIMATED QUANTITIES FOR STRIPING AND SIGNING											
ROAD	THERMO-PLASTIC EDGE CONTINUOUS WHITE	THERMO-PLASTIC SKIP YELLOW	THERMO-PLASTIC CONTINUOUS YELLOW	THERMO-PLASTIC LEGEND	THERMO-PLASTIC LEGEND	WARNING SIGNS	REGULATORY SIGNS	OBJECT MARKERS	WARNING SIGNS WITH SUPPLEMENTAL PLATE	RAISED PAVEMENT MARKERS	
	MILE	MILE	L.F.	L.F.	SQ. FT.	EACH	EACH	EACH	EACH	EACH	
A	10.303	1.960	43,160.0	306.0	0.0	34	8	8	6	0	
B	2.066	1.030	0.0	156.0	0.0	1	1	0	0	0	
C	2.614	1.218	4,270.0	480.0	126.0	7	1	4	0	0	
D	4.348	1.184	16,980.0	273.0	0.0	8	4	4	0	0	
E	4.869	1.906	11,614.0	225.0	0.0	13	7	8	2	0	
F	5.178	1.657	15,060.0	960.0	0.0	22	5	8	2	258	
G PART "A"	2.223	0.492	9,200.0	45.0	0.0	2	1	0	3	0	
G PART "B"	2.203	0.773	7,150.0	120.0	0.0	2	1	0	3	0	
H	12.052	2.400	48,776.0	702.0	0.0	26	8	4	8	0	
TOTAL PROJECT		45.856	12.620	156,210.0	3,267.0	126.0	115	36	36	24	258

NOTE: ALL BRIDGES TO BE STRIPED.

Rate of liquid asphalt application should be based on surface condition and type of existing surface. The rates of application should be varied by road based on the condition of each road. If application rates shown exceed those in the Specifications, Table 410-A, they should be approved by the Design Location Committee (County and District Engineer) at the PS&E plan review stage and evaluated prior to application of liquid asphalt per SOP SA II-1-91.

BASE REPAIR SCHEDULE							
Station - Station	Side	Length	Width	Area	Depth	Uncl. Exc. (F.M.)	HMA ST 19mm
		FT.	FT.	SQ. YD.	IN.	CU. YD.	TON
ROAD "A"							
TOTAL ROAD "A"						0.0	0.00
ROAD "B"							
25+00 - 25+30	LT.	30	5	16.67	6	2.8	5.50
45+00 - 46+25	LT.	125	3	41.67	6	6.9	13.80
55+25 - 56+00	LT.	75	5	41.67	6	6.9	13.80
61+35 - 61+50	RT.	15	6	10.00	6	1.7	3.30
TOTAL ROAD "B"						18.3	36.40
ROAD "C"							
65+00 - 65+30	LT.	30	6	20.00	6	3.3	6.60
90+87 - 91+25	LT.	38	3	12.67	6	2.1	4.20
95+25 - 96+00	LT.	75	5	41.67	6	6.9	13.80
104+35 - 105+00	RT.	65	2	14.44	6	2.4	4.80
TOTAL ROAD "C"						14.7	29.40
ROAD "D"							
285+00 - 285+30	LT.	30	6	20.00	6	3.3	6.60
300+00 - 300+25	RT.	25	4	11.11	6	1.9	3.67
315+25 - 316+00	LT.	75	5	41.67	6	6.9	13.75
354+35 - 354+50	C.L.	15	6	10.00	6	1.7	3.30
TOTAL ROAD "D"						13.8	27.32
ROAD "E"							
125+00 - 125+30	LT.	30	6	20.00	6	3.3	6.60
145+00 - 145+50	LT.	50	10	55.56	6	9.3	18.30
181+35 - 182+00	LT.	65	3	21.67	6	3.6	7.20
181+35 - 182+00	RT.	65	3	21.67	6	3.6	7.20
TOTAL ROAD "E"						19.8	39.30

BASE REPAIR SCHEDULE (CONT.)							
Station - Station	Side	Length	Width	Area	Depth	Uncl. Exc. (F.M.)	HMA ST 19mm
		FT.	FT.	SQ. YD.	IN.	CU. YD.	TON
ROAD "F"							
15+00 - 15+30	LT.	30	6	20.00	6	3.3	6.60
50+00 - 51+25	LT.	125	5	69.44	6	11.6	22.90
115+25 - 116+00	LT.	75	5	41.67	6	6.9	13.80
144+35 - 145+00	RT.	65	3	21.67	6	3.6	7.20
TOTAL ROAD "F"						25.4	50.50
ROAD "G" PART "A"							
195+00 - 195+30	RT.	130	4	57.78	6	9.6	19.10
225+00 - 226+35	LT.	125	2	27.78	6	4.6	9.20
247+95 - 248+00	LT.	5	2	1.11	6	0.2	0.40
TOTAL ROAD "G" PART "A"						14.4	28.70
ROAD "G" PART "B"							
192+15 - 192+20	RT.	5	5	2.78	6	0.5	0.90
195+64 - 195+75	RT.	11	2	2.44	6	0.4	0.80
215+25 - 216+00	LT.	75	5	41.67	6	6.9	13.80
244+35 - 245+00	LT.	65	3	21.67	6	3.6	7.20
TOTAL ROAD "G" PART "B"						11.4	22.70
ROAD "H"							
125+00 - 125+30	LT.	30	6	20.00	6	3.3	6.60
146+00 - 146+25	RT.	25	3	8.33	6	1.4	2.80
155+25 - 156+00	LT.	75	5	41.67	6	6.9	13.80
181+35 - 182+00	RT.	65	6	43.33	6	7.2	14.30
TOTAL ROAD "H"						18.8	37.50
PROJECT TOTALS:						136.6	271.82

LEVELING SCHEDULE					
Station - Station	Length	Width	Depth	Area	Leveling (HMA ST 9.5mm)
	FT.	FT.	IN.	SQ. YD.	TON
ROAD "A"					
TOTAL ROAD "A"				0.00	0.0
ROAD "B"					
10+00 - 11+50	150	18	1	300.00	16.5
25+25 - 26+25	100	5	1	55.56	3.1
35+00 - 37+00	200	10	1	222.22	12.2
40+00 - 42+50	250	18	1	500.00	27.5
62+45 - 64+45	200	5	1	111.11	6.1
TOTAL ROAD "B"				1188.89	65.4
ROAD "C"					
62+00 - 63+50	150	6	1	100.00	5.5
75+00 - 77+00	200	12	1	266.67	14.7
101+50 - 104+00	250	22	1	611.11	33.6
TOTAL ROAD "C"				977.78	53.8
ROAD "D"					
275+25 - 280+75	550	2	0.5	122.22	3.4
300+00 - 302+35	235	10	1	261.11	14.4
310+00 - 311+00	100	5	1	55.56	3.1
341+48 - 344+00	252	5	1	140.00	7.7
360+00 - 362+39	239	10	1	265.56	14.6
384+00 - 386+00	200	8	1	177.78	9.8
TOTAL ROAD "D"				1022.23	53.0
ROAD "E"					
141+50 - 144+00	250	5	1	138.89	7.6
155+00 - 156+00	100	5	1	55.56	3.1
195+50 - 197+00	150	10	1	166.67	9.2
210+84 - 211+34	50	20	1	111.11	6.1
211+54.5 - 211+69.5	15	20	1	33.33	1.8
TOTAL ROAD "E"				505.56	27.8
ROAD "F"					
10+00 - 14+00	390	6	1	260.00	14.3
72+50 - 74+50	200	10	1	222.22	12.2
121+70 - 124+20	250	5	0.5	138.89	3.8
TOTAL ROAD "F"				621.11	30.3
ROAD "G" PART "A"					
131+00 - 132+00	100	4	1	44.44	2.4
138+00 - 139+00	100	4	0.5	44.44	1.2
140+00 - 142+50	250	4	1	111.11	6.1
148+00 - 149+00	100	5	0.5	55.56	1.5
185+00 - 186+50	150	10	1	166.67	9.2
TOTAL ROAD "G" PART "A"				422.22	20.4

LEVELING SCHEDULE (CONT.)					
Station - Station	Length	Width	Depth	Area	Leveling (HMA ST 9.5mm)
	FT.	FT.	IN.	SQ. YD.	TON
ROAD "G" PART "B"					
132+00 - 133+00	100	10	1	111.11	6.1
152+30 - 153+80	150	4	1	66.67	3.7
172+00 - 173+00	100	10	1	111.11	6.1
185+00 - 186+00	100	6	1	66.67	3.7
TOTAL ROAD "G" PART "B"				355.56	19.6
ROAD "H"					
69+50 - 70+50	100	5	1	55.56	3.1
75+00 - 77+50	250	4	1	111.11	6.1
94+00 - 95+00	100	20	1	222.22	12.2
115+50 - 117+00	150	20	1	333.33	18.3
165+00 - 166+00	100	20	1	222.22	12.2
270+50 - 272+00	150	6	1	100.00	5.5
TOTAL ROAD "H"				1044.44	57.4
PROJECT TOTALS:					327.7

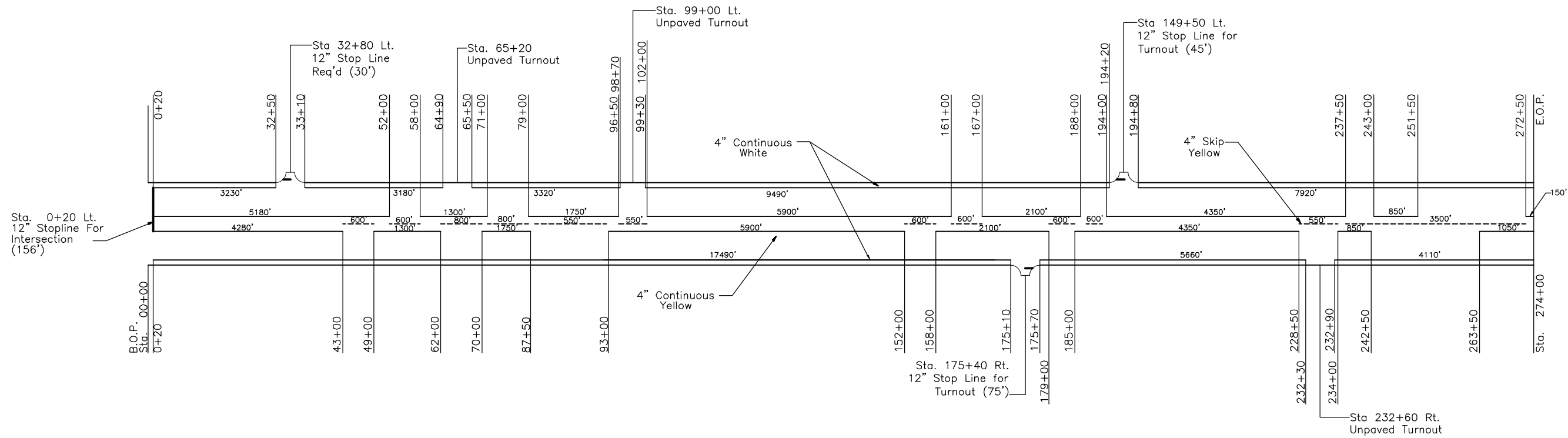

**ROAD "A"
TRAFFIC SIGNS REQ'D**

STATION	TYPE	REMARKS	SIDE
0+30	R1-1	Stop	Lt.
5+20	W3-1	Stop Ahead	Lt.
6+50	W1-2L	Curve With	Rt.
	W13-1	Advisory Speed Plate 40MPH	
15+50	W1-2L	Curve	Rt.
17+75	W1-2R	Curve With	Lt.
	W13-1	Advisory Speed Plate 40MPH	
25+00	W1-2L	Curve With	Rt.
	W13-1	Advisory Speed Plate 40MPH	
26+00	W1-2R	Curve	Lt.
29+80	W2-2	Side Road Lt.	Rt.
32+65	R1-1	Stop	Lt.
32+65	W3-1	Stop Ahead	Lt300'
32+80	W1-7	Large Arrow (Two Directions)	Rt.
35+80	W2-2	Side Road Rt.	Lt.
39+00	W1-2L	Curve With	Lt.
	W13-1	Advisory Speed Plate 40MPH	
62+20	W2-2	Side Road Lt.	Rt.
64+95	R1-1	Stop	Lt.
65+10	W1-7	Large Arrow (Two Directions)	Rt.
68+20	W2-2	Side Road Rt.	Lt.
82+50	W1-2L	Curve With	Rt.
	W13-1	Advisory Speed Plate 40MPH	

**ROAD "A" CONTINUED
TRAFFIC SIGNS REQ'D**

STATION	TYPE	REMARKS	SIDE
93+00	W1-2R	Curve With	Lt.
	W13-1	Advisory Speed Plate 40MPH	
94+90	W2-2	Side Road Lt.	Rt.
95+25	W1-2R	Curve	Rt.
98+85	R1-1	Stop	Lt.
98+85	W3-1	Stop Ahead	Lt300'
99+00	W1-7	Large Arrow (Two Directions)	Rt.
100+90	W2-2	Side Road Rt.	Lt.
105+45	W1-2L	Curve	Lt.
143+50	W1-2R	Curve	Rt.
157+50	W1-2L	Curve	Lt.
161+50	W1-2L	Curve	Rt.
172+40	W2-2	Side Road Rt.	Rt.
175+40	W1-7	Large Arrow (Two Directions)	Lt.
175+55	R1-1	Stop	Rt.
177+00	W3-1	Stop Ahead	Rt300'
178+40	W2-2	Side Road Lt.	Lt.
191+50	W2-2	Side Road Lt.	Rt.
194+35	R1-1	Stop	Lt.
194+50	W1-7	Large Arrow (Two Directions)	Rt.
197+50	W2-2	Side Road Rt.	Lt.
203+50	W1-4L	Reverse Curve	Rt.

**ROAD "A" CONTINUED
TRAFFIC SIGNS REQ'D**

STATION	TYPE	REMARKS	SIDE
214+75	OM-3L	Object Marker	Lt.
214+75	OM-3R	Object Marker	Rt.
215+95	OM-3L	Object Marker	Rt.
215+95	OM-3R	Object Marker	Lt.
224+00	W1-2R	Curve	Rt.
224+75	W1-4L	Reverse Curve	Lt.
225+62	OM-3L	Object Marker	Lt.
225+62	OM-3R	Object Marker	Rt.
226+56	OM-3L	Object Marker	Rt.
226+56	OM-3R	Object Marker	Lt.
230+35	W2-2	Side Road Rt.	Rt.
232+60	W1-7	Large Arrow (Two Directions)	Lt.
232+75	R1-1	Stop	Rt.
232+75	W3-1	Stop Ahead	Rt.
236+35	W2-2	Side Road Lt.	Lt.
269+00	W3-1	Stop Ahead	Rt.
274+00	R1-1	Stop	Rt300'
Road "A"			
34	Warning Signs Req'd.		
8	Regulatory Signs Req'd.		
8	Object Markers Req'd.		
6	Warning Signs With Supp. Plates Req'd.		

Note: Vandal Resistant Hardware Required.

**ROAD "A"
STRIPING DETAIL (N.T.S.)**

85 Percentile Speed = 55 MPH
Minimum Passing Sight Distance = 900 Ft.

- 4" Thermoplastic Skip Yellow - 1.960 Mi.
- 4" Thermoplastic Continuous White - 10.303 Mi.
- 4" Thermoplastic Continuous Yellow - 43,160 L.F.
- Thermoplastic Legend (White) - 306.0 L.F.

If turnout and intersection pavement markings are different from examples on SA-PSM-1, details similar to those shown in Chapter 9 of The Design Manual must be shown.

A board order is required to establish a speed limit for less than 55 MPH for striping or signing. (Also for speed limits within school zones. See MUTCD Chapter 7B.)

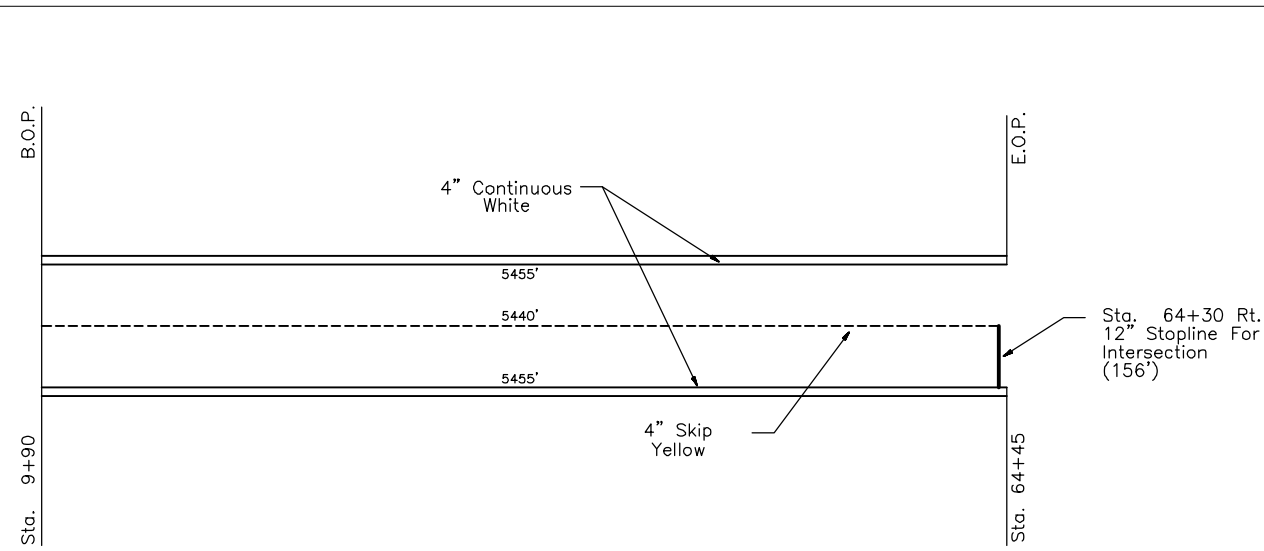

ROAD "B"
STRIPING DETAIL (N.T.S.)

85 Percentile Speed = 55 MPH
Minimum Passing Sight Distance = 900 Ft.

- 4" Thermoplastic Skip Yellow - 1.030 Mi.
- 4" Thermoplastic Continuous White - 2.066 Mi.
- Thermoplastic Legend (White) - 156.0 L.F.

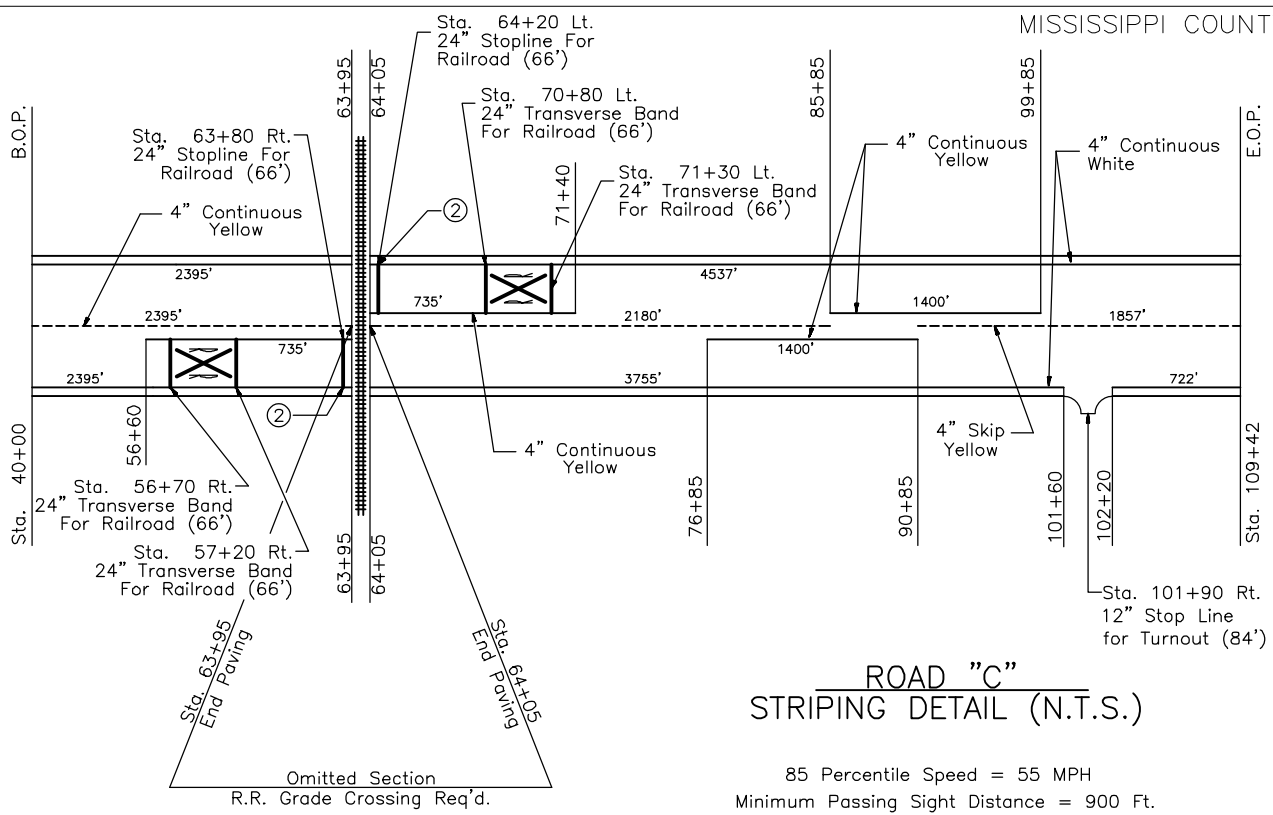

ROAD "C"
STRIPING DETAIL (N.T.S.)

85 Percentile Speed = 55 MPH
Minimum Passing Sight Distance = 900 Ft.

- 4" Thermoplastic Skip Yellow - 1.218 Mi.
- 4" Thermoplastic Continuous White - 2.614 Mi.
- 4" Thermoplastic Continuous Yellow - 4,270 L.F.
- Thermoplastic Legend (White) - 480 L.F.
- Thermoplastic Legend (White) - 126 Sq. Ft.

ROAD "B"			
TRAFFIC SIGNS REQ'D			
STATION	TYPE	REMARKS	SIDE
59+50	W3-1	Stop Ahead	Rt.
64+25	R1-1	Stop	Rt.
Road "B"			
1	Warning Signs Req'd.		
1	Regulatory Signs Req'd.		

Note: Vandal Resistant Hardware Required.

ROAD "C"			
TRAFFIC SIGNS REQ'D			
STATION	TYPE	REMARKS	SIDE
47+00	W1-2L	Curve	Lt.
48+20	OM-3R	Object Marker	Rt.
48+20	OM-3L	Object Marker	Lt.
49+60	OM-3L	Object Marker	Rt.
49+60	OM-3R	Object Marker	Lt.
56+80	W10-1	R.R. Advance Warning Sign	Rt.
71+20	W10-1	R.R. Advance Warning Sign	Lt.
78+85	W1-2L	Curve	Rt.
97+85	W2-2R	Curve	Lt.
98+90	W2-2	Side Road Rt.	Rt.
102+10	R1-1	Stop	Rt.
104+90	W2-2	Side Road Lt.	Lt.
Road "C"			
7	Warning Signs Req'd.		
1	Regulatory Signs Req'd.		
4	Object Markers Req'd.		

Note: Vandal Resistant Hardware Required.

- ① At R.R. crossings without signals and gates add a W10-13P plaque beneath the W10-1 sign.
- ② At R.R. crossings without signals add a Stop sign R1-1 or Yield sign R1-2 and Stop Ahead sign W3-1 or Yield Ahead sign W3-2 per MUTCD 2009 Edition, Section 8B.04.

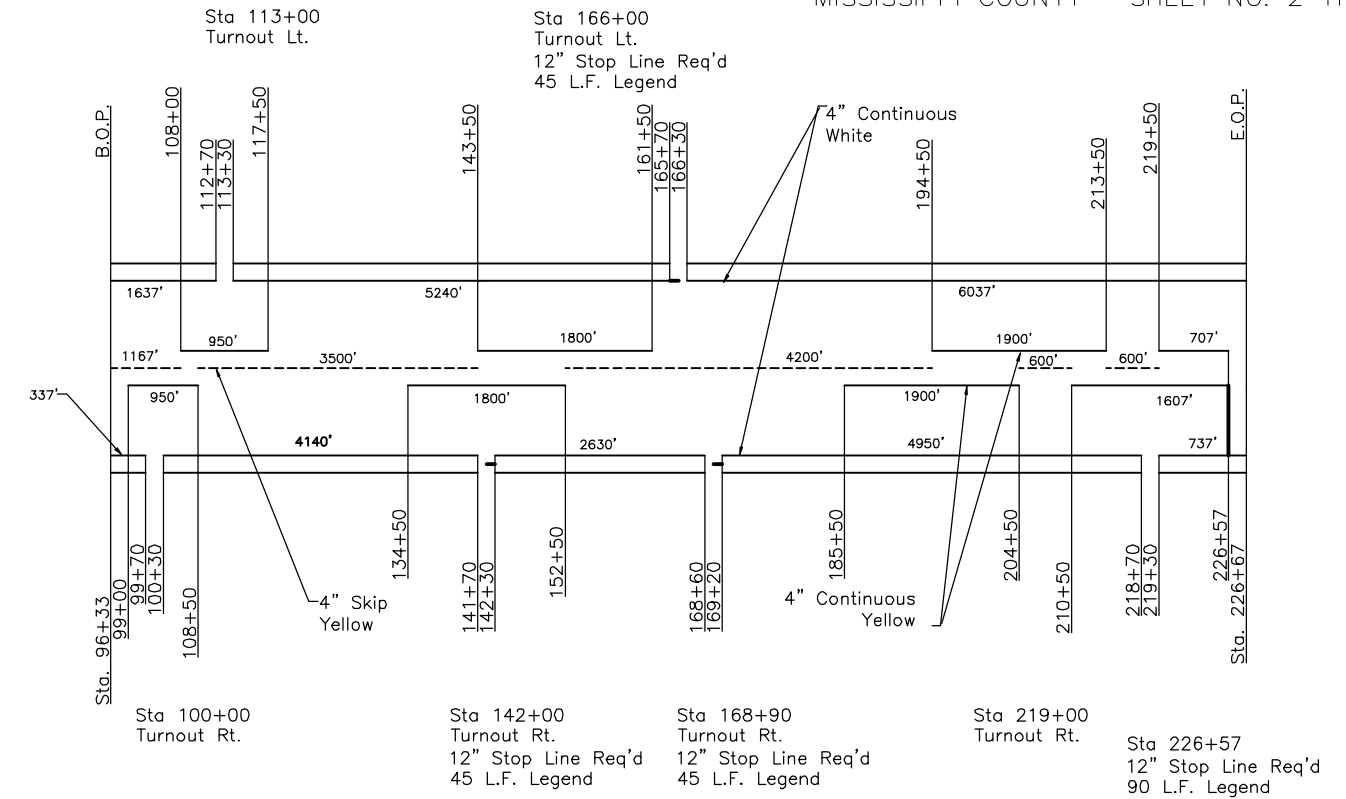
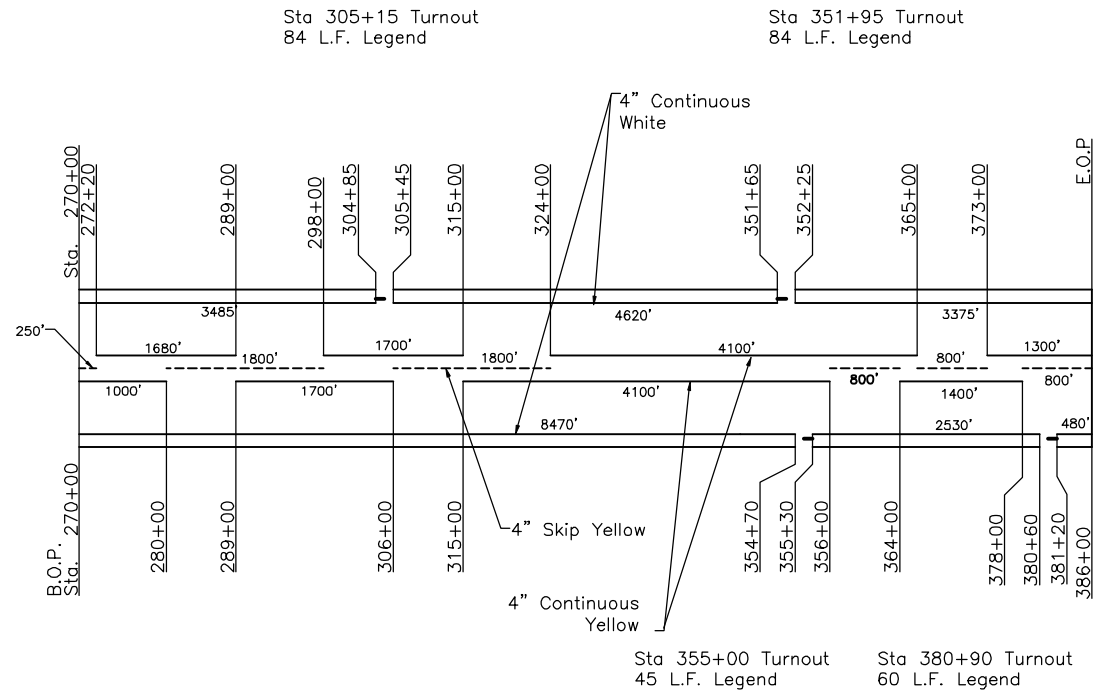

**ROAD "D"
TRAFFIC SIGNS REQ'D**

STATION	TYPE	REMARKS	SIDE
305+00	R1-1	Stop	Lt.
305+00	W3-1	Stop Ahead	300' Lt.
305+15	W1-7	Large Arrow (Two Directions)	Rt.
347+58	OM-3R	Object Marker	Rt.
347+58	OM-3L	Object Marker	Lt.
348+18	OM-3L	Object Marker	Rt.
348+18	OM-3R	Object Marker	Lt.
351+80	R1-1	Stop	Lt.
351+80	W3-1	Stop Ahead	300' Lt.
351+95	W1-7	Large Arrow (Two Directions)	Rt.
355+00	W1-7	Large Arrow (Two Directions)	Lt.
355+15	R1-1	Stop	Rt.
355+15	W3-1	Stop Ahead	300' Rt.
380+90	W1-7	Large Arrow (Two Directions)	Lt.
381+00	R1-1	Stop	Rt.
381+00	W3-1	Stop Ahead	300' Rt.

Road "D"			
8	Warning Signs Req'd.		
4	Regulatory Signs Req'd.		
4	Object Markers Req'd.		

Note: Vandal Resistant Hardware Required.

**ROAD "D"
STRIPING DETAIL (N.T.S.)**

85 Percentile Speed = 55 MPH
Minimum Passing Sight Distance = 900 Ft.

- 4" Thermoplastic Skip Yellow - 1.184 Mi.
- 4" Thermoplastic Continuous White - 4.348 Mi.
- 4" Thermoplastic Continuous Yellow - 16,980 L.F.
- Thermoplastic Legend (White) - 273 L.F.

**ROAD "E"
TRAFFIC SIGNS REQ'D**

STATION	TYPE	REMARKS	SIDE
100+05	R1-1	Stop	Rt.
100+15	W3-1	Stop Ahead	300' Rt.
106+59	W1-2R	Curve Sign	Lt.
112+85	R1-1	Stop	Lt.
112+85	W3-1	Stop Ahead	300' Lt.
137+00	W1-2L	Curve Sign	Rt.
142+00	W1-7	Large Arrow (Two Directions)	Lt.
142+15	R1-1	Stop	Rt.
142+15	W3-1	Stop Ahead	300' Rt.
145+51	OM-3R	Object Marker	Rt.
145+51	OM-3L	Object Marker	Lt.
146+10	OM-3L	Object Marker	Rt.
146+10	OM-3R	Object Marker	Lt.
147+30	W1-2R	Curve	Lt.
148+34	W1-2L	Curve With	Rt.
	W13-1	Advisory Speed Plate 40 MPH	
157+25	W1-2R	Curve With	Lt.
	W13-1	Advisory Speed Plate 40 MPH	
165+85	R1-1	Stop	Lt.
165+85	W3-1	Stop Ahead	300' Lt.
165+95	W1-7	Large Arrow (Two Directions)	Rt.
168+95	W1-7	Large Arrow (Two Directions)	Lt.
169+05	R1-1	Stop	Rt.

**ROAD "E"
STRIPING DETAIL (N.T.S.)**

85 Percentile Speed = 55 MPH
Minimum Passing Sight Distance = 900 Ft.

- 4" Thermoplastic Skip Yellow - 1.906 Mi.
- 4" Thermoplastic Continuous White - 4.869 Mi.
- 4" Thermoplastic Continuous Yellow - 11,614 L.F.
- Thermoplastic Legend (White) - 225.0 L.F.

**ROAD "E" CONTINUED
TRAFFIC SIGNS REQ'D**

STATION	TYPE	REMARKS	SIDE
169+05	W3-1	Stop Ahead	300' Rt.
211+34	OM-3R	Object Marker	Rt.
211+34	OM-3L	Object Marker	Lt.
211+54	OM-3L	Object Marker	Rt.
211+54	OM-3R	Object Marker	Lt.
219+15	R1-1	Stop	Rt.
219+15	W3-1	Stop Ahead	300' Rt.
219+00	W1-7	Large Arrow (Two Directions)	Lt.
226+57	R1-1	Stop	Rt.

Road "E"	
13	Warning Signs Req'd.
7	Regulatory Signs Req'd.
8	Object Markers Req'd.
2	Warning Signs With Supp. Plates Req'd.

Note: Vandal Resistant Hardware Required.

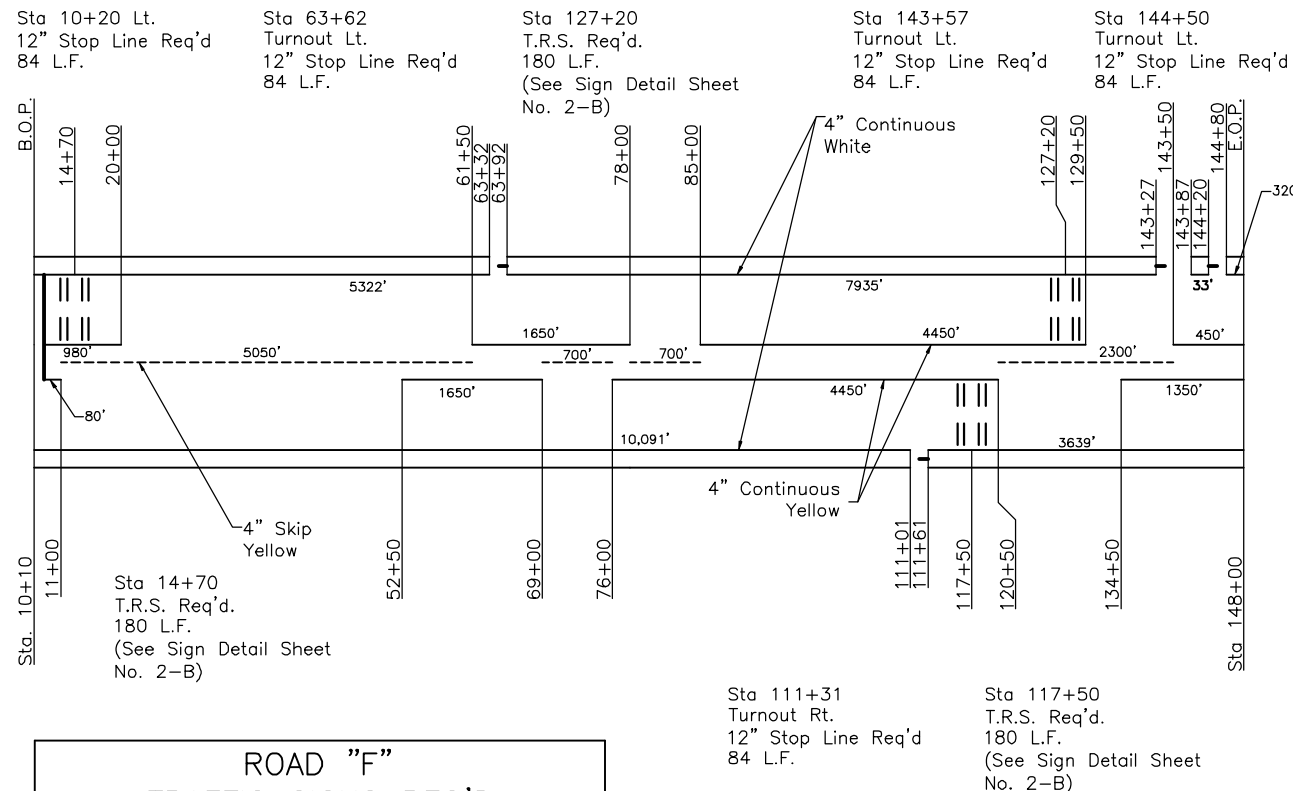

**ROAD "F"
TRAFFIC SIGNS REQ'D**

STATION	TYPE	REMARKS	SIDE
10+20	R1-1	Stop Sign	Lt.
14+70	W3-1	Stop Ahead Sign	Lt.
38+05	OM-3R	Object Marker	Rt.
38+05	OM-3L	Object Marker	Lt.
38+62	OM-3L	Object Marker	Rt.
38+62	OM-3R	Object Marker	Lt.
44+11	OM-3R	Object Marker	Rt.
44+11	OM-3L	Object Marker	Lt.
45+65	OM-3L	Object Marker	Rt.
45+65	OM-3R	Object Marker	Lt.
54+50	W1-2R	Curve	Rt.
63+50	R1-1	Stop	Lt.
63+50	W3-1	Stop Ahead	300' Lt.
63+62	W1-7	Large Arrow (Two Directions)	Rt.
65+62	W1-2L	Curve	Lt.
65+66	W1-2L	Curve	Rt.
76+00	W1-2R	Curve	Lt.
80+00	W1-5R	Curve	Rt.
110+50	W1-5R	Curve	Lt.
111+14	R1-1	Stop	Rt.
111+14	W3-1	Stop Ahead	300' Rt.
117+31	W1-7	Large Arrow (Two Directions)	Lt.
117+50	W1-2R	Curve With	Rt.
	W13-1	Advisory Speed Plate 40 MPH	
118+75	W1-8L	Chevron	Lt. *
119+95	W1-8R/L	Chevron	Lt. *
121+15	W1-8R/L	Chevron	Lt. *
122+35	W1-8R/L	Chevron	Lt. *
123+55	W1-8R/L	Chevron	Lt. *

* See Detail Sheet No. 2-B

**ROAD "F"
STRIPING DETAIL (N.T.S.)**

85 Percentile Speed = 55 MPH
Minimum Passing Sight Distance = 900 Ft.

- 4" Thermoplastic Skip Yellow - 1.657 Mi.
- 4" Thermoplastic Continuous White - 5.178 Mi.
- 4" Thermoplastic Continuous Yellow - 15,060 L.F.
- Thermoplastic Legend (White) - 960 L.F.
- Reflective Markers - 258 Ea.

**ROAD "F" CONTINUED
TRAFFIC SIGNS REQ'D**

124+75	W1-8R/L	Chevron	Lt. *
125+95	W1-8R/L	Chevron	Lt. *
127+20	W1-2L	Curve With	Lt.
	W13-1	Advisory Speed Plate 40 MPH	
143+45	R1-1	Stop	Lt.
143+45	W3-1	Stop Ahead	300' Lt.
143+57	W1-7	Large Arrow (Two Directions)	Rt.
144+40	R1-1	Stop	Lt.
144+40	W3-1	Stop Ahead	300' Lt.
144+50	W1-7	Large Arrow (Two Directions)	Rt.

Road "F"

- 22 Warning Signs Req'd.
- 5 Regulatory Signs Req'd.
- 8 Object Markers Req'd.
- 2 Warning Signs With Supp. Plates Req'd.

Note: Vandal Resistant Hardware Required.

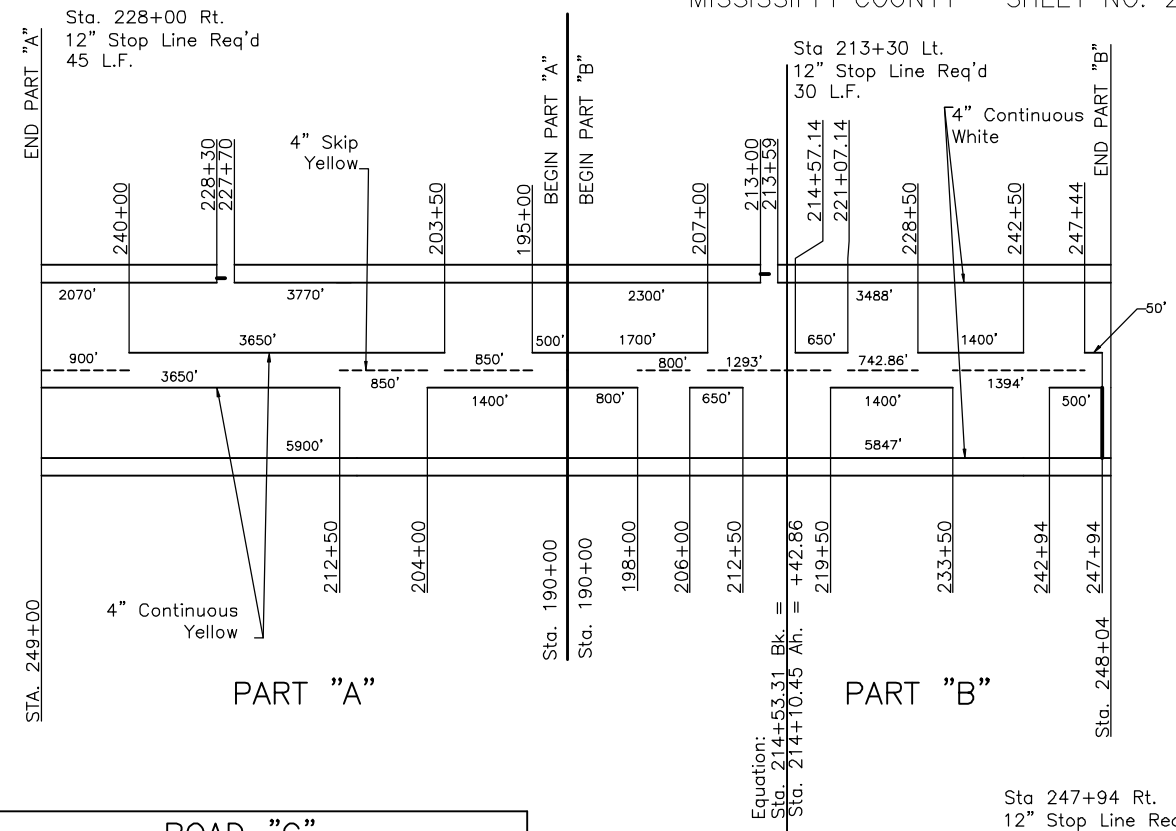

**ROAD "G"
TRAFFIC SIGNS REQ'D**

STATION	TYPE	REMARKS	SIDE
PART "A"			
199+32	W1-2R	Curve With	Lt.
	W13-1	Advisory Speed Plate 35 MPH	
200+12	W1-2R	Curve With	Rt.
	W13-1	Advisory Speed Plate 40 MPH	
228+05	W1-7	Large Arrow (Two Directions)	Lt.
228+15	R1-1	Stop	Rt.
228+15	W3-1	Stop Ahead	300' Rt.
231+34	W1-2L	Curve With	Lt.
	W13-1	Advisory Speed Plate 40 MPH	
2	Warning Signs Req'd		
1	Regulatory Signs Req'd		
3	Warning Signs With Supp. Plates Req'd		
PART "B"			
191+53	W1-2L	Curve With	Lt.
	W13-1	Advisory Speed Plate 35 MPH	
207+54	W1-2R	Curve With	Rt.
	W13-1	Advisory Speed Plate 40 MPH	
213+12	R1-1	Stop	Lt.
213+12	W3-1	Stop Ahead	300' Lt.
213+22	W1-7	Large Arrow (Two Directions)	Rt.
217+10	W1-2L	Curve With	Lt.
	W13-1	Advisory Speed Plate 40 MPH	
2	Warning Signs Req'd		
1	Regulatory Signs Req'd		
3	Warning Signs With Supp. Plates Req'd		

Note: Vandal Resistant Hardware Required.

**ROAD "G"
STRIPING DETAIL (N.T.S.)**

PART "A"
85 Percentile Speed = 55 MPH
Minimum Passing Sight Distance = 900 Ft.

- 4" Thermoplastic Skip Yellow - 0.492 Mi.
- 4" Thermoplastic Continuous White - 2.223 Mi.
- 4" Thermoplastic Continuous Yellow - 9,200.0 L.F.
- Thermoplastic Legend (White) - 45.0 L.F.

PART "B"
85 Percentile Speed = 55 MPH
Minimum Passing Sight Distance = 900 Ft.

- 4" Thermoplastic Skip Yellow - 0.801 Mi.
- 4" Thermoplastic Continuous White - 2.203 Mi.
- 4" Thermoplastic Continuous Yellow - 7,150.0 L.F.
- Thermoplastic Legend (White) - 120.0 L.F.

ROADS "F" AND "G"

PAVEMENT MARKING DETAILS AND TRAFFIC SIGN SCHEDULE SHEET

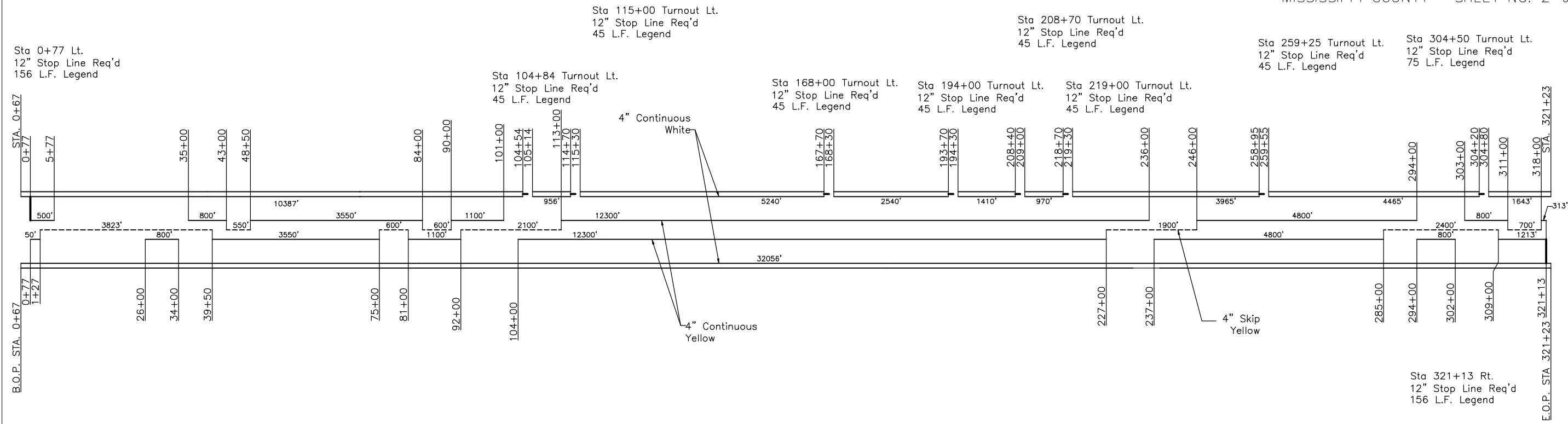

ROAD "H" TRAFFIC SIGNS REQ'D

STATION	TYPE	REMARKS	SIDE
0+77	R1-1	Stop	Lt.
5+77	W3-1	Stop Ahead	Lt.
40+89	OM-3R	Object Marker	Rt.
41+10	OM-3L	Object Marker	Lt.
57+53	W1-4R	Reverse Curve With	
	W13-1	Advisory Speed Plate 40 MPH	Rt.
65+09	OM-3R	Object Marker	Rt.
65+18	OM-3L	Object Marker	Lt.
73+65	W1-4R	Reverse Curve With	
	W13-1	Advisory Speed Plate 40 MPH	Lt.
104+69	R1-1	Stop	Lt.
104+69	W3-1	Stop Ahead	Lt.300'
108+16	W1-2R	Curve	Rt.
121+14	W1-2L	Curve	Lt.
121+21	W1-2R	Curve	Rt.
130+00	W1-2L	Curve	Lt.
159+05	W1-2R	Curve With	
	W13-1	Advisory Speed Plate 40 MPH	Rt.
168+00	R1-1	Stop	Lt.
168+00	W3-1	Stop Ahead	Lt.300'
168+10	W1-7	Large Arrow (Two Directions)	Rt.
171+35	W1-2L	Curve With	
	W13-1	Advisory Speed Plate 40 MPH	Lt.

ROAD "H" CONTINUED TRAFFIC SIGNS REQ'D

STATION	TYPE	REMARKS	SIDE
175+90	W1-2L	Curve With	
	W13-1	Advisory Speed Plate 30 MPH	Rt.
188+31	W1-2R	Curve With	
	W13-1	Advisory Speed Plate 30 MPH	Lt.
190+18	W1-2R	Curve	Rt.
193+85	R1-1	Stop	Lt.
193+85	W3-1	Stop Ahead	Lt.300'
208+55	R1-1	Stop	Lt.
208+55	W3-1	Stop Ahead	Lt.300'
208+65	W1-7	Large Arrow	Rt.
213+79	W1-2L	Curve	Lt.
218+85	R1-1	Stop	Lt.
218+85	W3-1	Stop Ahead	Lt.300'
218+95	W1-7	Large Arrow	Rt.
221+06	W1-2L	Curve With	
	W13-1	Advisory Speed Plate 40 MPH	Rt.
233+67	W1-2R	Curve With	
	W13-1	Advisory Speed Plate 40 MPH	Lt.
240+79	W1-2R	Curve	Rt.
249+44	W1-2L	Curve	Lt.
253+60	W1-2L	Curve	Rt.

ROAD "H" CONTINUED TRAFFIC SIGNS REQ'D

STATION	TYPE	REMARKS	SIDE
259+25	R1-1	Stop	Lt.
259+25	W3-1	Stop Ahead	Lt.300'
259+35	W1-7	Large Arrow (Two Directions)	Rt.
264+30	W1-2R	Curve	Lt.
297+42	W1-2R	Curve	Rt.
304+50	W1-7	Large Arrow (Two Directions)	Rt.
307+40	W1-2L	Curve	Lt.
316+13	W3-1	Stop Ahead	Rt.300'
321+13	R1-1	Stop	Rt.
321+49	W1-7	Large Arrow (Two Directions)	
Road "H"			
26	Warning Signs Req'd.		
8	Regulatory Signs Req'd.		
4	Object Markers Req'd.		
8	Warning Signs With Supp. Plates Req'd.		

ROAD "H" STRIPING DETAIL (N.T.S.)

85 Percentile Speed = 55 MPH
Minimum Passing Sight Distance = 900 Ft.

- 4" Thermoplastic Skip Yellow - 2,400 Mi.
- 4" Thermoplastic Continuous White - 12,052 Mi.
- 4" Thermoplastic Continuous Yellow - 48,776 L.F.
- Thermoplastic Legend (White) - 702.0 L.F.

Note: Vandal Resistant Hardware Required.

CONSTRUCTION NOTES:

- "FLAGGER AHEAD" SIGNS AND FLAGGERS WILL BE REQUIRED AT EACH END OF A SHOT TO CONTROL TRAFFIC UNTIL EACH SHOT IS ENTIRELY COVERED WITH AGGREGATE. DEFINITE CARE SHOULD BE MADE TO CONTROL THE SPEED OF VEHICLES TRAVELING OVER NEW RESEAL WORK. THIS APPLIES TO CONTRACTOR VEHICLES AS WELL AS THE TRAVELING PUBLIC.
- A "ROAD WORK AHEAD" (W20-1) SIGN WITH A 35 MPH (W13-1) ADVISORY SPEED PLAQUE MOUNTED ON A PORTABLE STAND SHALL BE PLACED AT EACH END OF THE ROAD DURING RESEAL OPERATIONS. SIMILAR PORTABLE SIGNS SHALL BE LOCATED ON THE RIGHT SIDE OF THE PROJECT ROAD BEFORE AND AFTER EACH INTERSECTION DESIGNATED IN THE "SCHEDULE OF MAJOR ROAD INTERSECTIONS".
- DURING BASE REPAIR, LEVELING OR RESEAL OPERATIONS, ONE LANE OF TRAFFIC WILL BE KEPT OPEN AS SHOWN BY THE "ONE LANE CLOSURE" DETAIL; HOWEVER, THE CONTRACTOR MAY CLOSE BOTH LANES AS SHOWN BY THE "TEMPORARY ROAD CLOSURE" DETAIL (MUTCD FIGURE 6H-13) FOR UP TO 20 MINUTES, AT WHICH TIME ONE LANE TRAFFIC WILL RESUME. PERIODS LONGER THAN 20 MINUTES MUST BE APPROVED BY THE COUNTY ENGINEER AND WILL REQUIRE A ROAD CLOSURE TRAFFIC CONTROL PLAN.
- TEMPORARY RAISED PAVEMENT MARKERS SHALL BE REQUIRED AS PER S-619.08 OF THE STANDARD SPECIFICATIONS. THE CONTRACTOR SHALL REPLACE RAISED PAVEMENT MARKERS AS NECESSARY. THE CONTRACTOR SHALL INCLUDE THE MATERIALS AND LABOR FOR INSTALLATION OF THESE MARKERS IN THE MAINTENANCE OF TRAFFIC PAY ITEM NO. S-618-A. THERE SHALL BE NO SEPARATE PAY ITEM FOR THIS WORK. THE RAISED PAVEMENT MARKERS SHALL BE INSTALLED PRIOR TO APPLICATION OF THE SEAL COAT.
- PRIOR TO THE APPLICATION OF THE RESEAL, "DO NO PASS" (R4-1) OR "PASS WITH CARE" (R4-2) SIGNS SHALL BE INSTALLED ON THE RIGHT HAND SIDE OF THE ROAD AT THE B.O.P., E.O.P. AND THE BEGINNING AND END OF EACH NO PASSING ZONES IN ACCORDANCE WITH THE PERMANENT STRIPING SCHEDULE IN THE PLANS. "NO PASSING ZONE" (W14-3) SIGNS SHALL BE INSTALLED ON THE LEFT HAND SIDE OF THE ROADWAY AT EACH R4-1. THESE SIGNS SHALL REMAIN IN PLACE UNTIL THE PERMANENT CENTERLINE STRIPING IS IN PLACE.
- TRAFFIC CONTROL DEVICES SHALL BE INSTALLED WHENEVER NECESSARY, REMAIN IN PLACE ONLY AS LONG AS THEY ARE NEEDED AND BE REMOVED IMMEDIATELY THEREAFTER.
- TRAFFIC CONTROL DEVICES SHALL CONFORM TO THE APPLICABLE SPECIFICATIONS OF THE "MANUAL ON UNIFORM TRAFFIC CONTROL DEVICES", LATEST EDITION.
- THESE ARE MINIMUM REQUIREMENTS AND IN NO WAY RELIEVE THE CONTRACTOR OF HIS OBLIGATIONS TO MAINTAIN TRAFFIC IN A SAFE MANNER.
- CONTRACTOR SHALL INSTALL TRAFFIC CONTROL DEVICES SUCH AS CONES, DRUMS, FLASHERS, BARRICADES, SIGNS, ETC. TO SAFELY CHANNEL OR DIRECT TRAFFIC. WHEN NECESSARY, FLAGGERS SHALL BE USED IN CONJUNCTION WITH THE TRAFFIC CONTROL DEVICES, FLAGGER AHEAD SIGNS ARE REQUIRED IN ADVANCE OF FLAGGERS, EXCEPT DURING BRIEF PERIODS AND EMERGENCY SITUATIONS.
- SEE STANDARD DRAWINGS 6358 AND SA-TSP-1 FOR CORRECT PLACEMENT AND INSTALLATION OF BARRICADES AND SIGNS.
- PAYMENT FOR INSTALLATION, MAINTENANCE AND REMOVAL OF TRAFFIC CONTROL DEVICES WILL BE MADE UNDER PAY ITEM S-618-A AND S-618-B.
- SEE SPECIAL PROVISION NO. 901-S-618-1 FOR ADDITIONAL REQUIREMENTS.

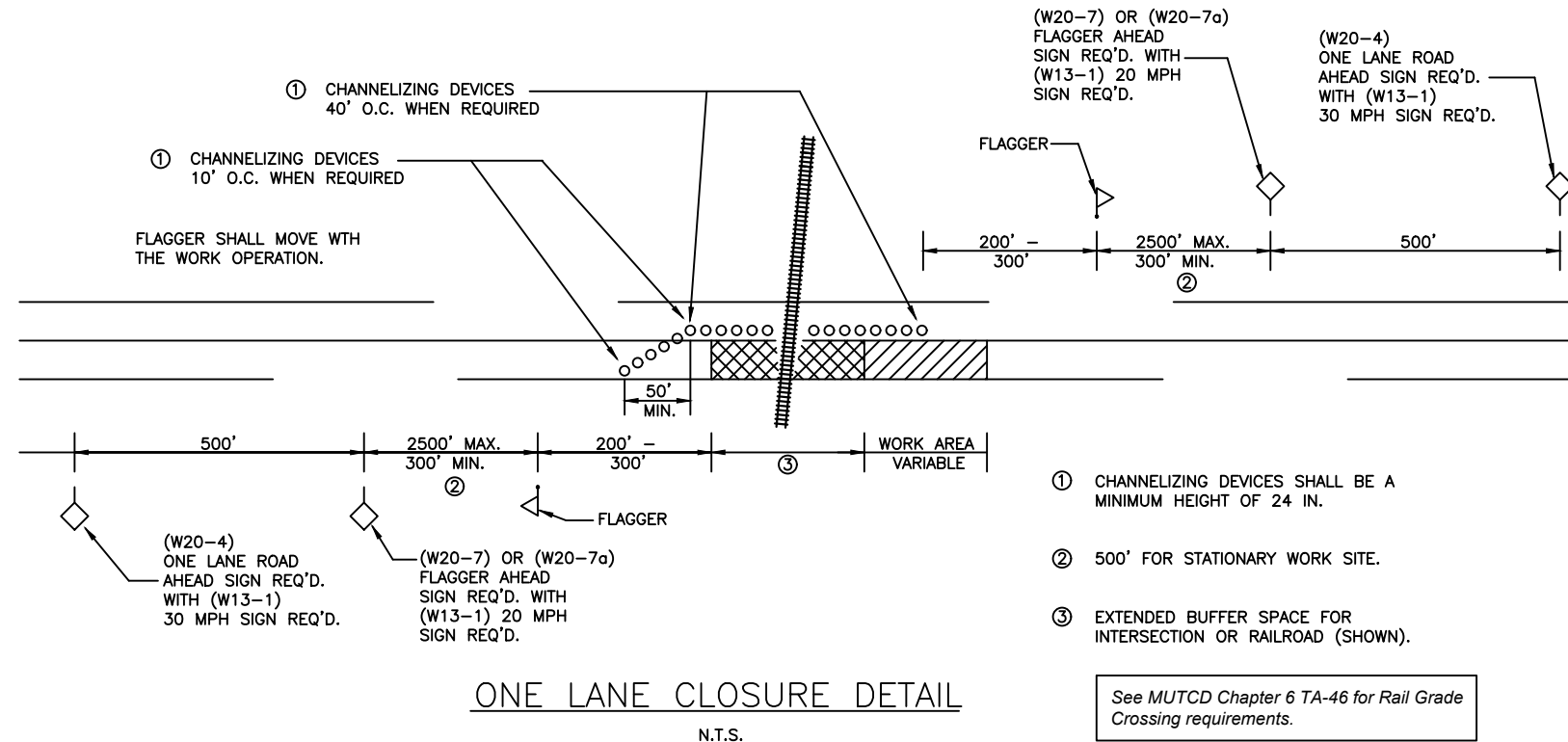

TRAFFIC SIGN NOTE:

EXISTING TRAFFIC SIGNS SHALL REMAIN IN PLACE AND BE MAINTAINED BY THE CONTRACTOR UNTIL THE PROJECT IS COMPLETED AND PERMANENT SIGNS ARE INSTALLED UNLESS THE EXISTING SIGNS INTERFERE WITH AND/OR CONFLICT WITH CONSTRUCTION SIGNS. IF ANY EXISTING TRAFFIC SIGNS WITHIN THE PROJECT LIMITS ARE IN CONFLICT WITH THE PROJECT CONSTRUCTION, THEY SHALL BE RELOCATED SO AS TO SERVE THEIR ORIGINAL PURPOSE.

STRIPING OPERATION NOTES:

- A SHADOW VEHICLE SHALL BE POSITIONED APPROXIMATELY 300 FT. IN FRONT OF AND BEHIND PAINTING OPERATIONS.
- THE SHADOW VEHICLE SHALL CARRY SIGNS "ROADWAY STRIPING AHEAD". BOTTOM OF SIGN SHALL BE A MINIMUM OF SIX (6) FT. ABOVE THE PAVEMENT.
- A FLASHING YELLOW LIGHT SHALL BE INSTALLED ABOVE THE TOP OF WARNING SIGNS.
- A FLASHING YELLOW LIGHT SHALL BE INSTALLED ON ALL VEHICLES USED IN THE MARKING OPERATIONS.

SCHEDULE OF MAJOR ROAD INTERSECTIONS
(See Note 2.)

ROAD "A"	NONE
ROAD "B"	NONE
ROAD "C"	STA. 101+90
ROAD "D"	STA. 355+00
ROAD "E"	STA. 168+90
ROAD "F"	STA. 63+62
ROAD "G"	STA. 228+00
ROAD "G" PART "A"	STA. 213+30
ROAD "G" PART "B"	STA. 104+84
ROAD "H"	STA. 259+25

Please attach the traffic control narrative (SP 901-S-618-1) to this sheet in each set of review plans.